

**DOUWE
EGBERTS**



MARCILLA



**MAISON
DU
CAFE**



A **SaraLee** Company

Cafitesse 60



Gebruiksaanwijzing
Mode d'emploi
Bedienungsanleitung
Operator manual
Instrucciones de servicio

January 2007
Article no. 700.403.422-B

Serial number: — — — — —

Registration number: — — — — —

Phone number service: — — — — —

Supplier: — — — — —

Table of contents

Introduction	1
Safety instructions	2
Description of the dispenser “CAFITESSE 60”	4
Display pictograms	5
Operating panel (tapping beverages)	6
Programming buttons	6
Operation of the dispenser	7
Switching on the dispenser	7
Switching off the dispenser	7
Filling the water tank	8
Placing/replace ingredient pack	9
Dispensing a cup of drink	10
Dispensing a pot of drink	11
Dispensing hot water	12
Moving the dispenser with water tank	13
Preparation	13
Moving the dispenser	14
Access to the operator menu	15
Counter readings consumptions	16
CLEANING - Manual, daily cleaning procedure	18
CLEANING - Automatic, periodic cleaning procedure	20
Cleaning program	20
Start the cleaning program	21
Changing the settings	24
Clock setting: set date and time	24
Language setting	26
Switching text on or off	27
“Almost empty” Warning	28
Volume setting	29
Strength setting	30
Descaling the dispenser	31
Start descaling program (Optional)	32
Putting the dispenser into service after storage / Storing the dispenser	35
Display messages and troubleshooting	36
Display messages and troubleshooting when using model with removable watertank	39
Quick reference	40
Serve a drink and hot water	40
Daily cleaning	41
Periodic cleaning	42
Specifications	43
Subject index	44

Introduction

This manual contains the instructions and explanation of the operation and maintenance of the "CAFITESSE 60" dispenser.

The dispenser is a machine for preparing warm drinks and hot water by the cup or pot.

There are 2 models:

- one model with a fixed water connection (C61)*/**,
- one model with a removable water tank (C60)*.

The dispenser cooling compartment has room for two ingredient packs. The right-hand ingredient pack always contains coffee.

Depending on the ingredients that you put there, the dispenser can dispense coffee, decaffeinated coffee, or coffee with milk drinks such as cappuccino.

The dispenser is easy to operate. All aspects of the design are oriented towards ease of use. Cleaning the dispenser is simple and requires very little time.

Follow the instructions for operation and maintenance in this manual so that the dispenser works well.

*) Optional: a cold water system can be connected to the machine.

**) Optional: an extra tap water system can be mounted in the machine.

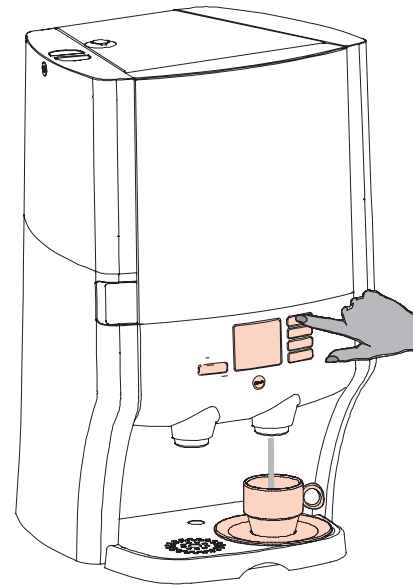

Caution!

- Read the safety instructions carefully.
- Do you have any questions? Ask your Cafitesse system supplier.
- The manufacturer and DECS International are not liable for any damage and/or injury if the dispenser is not operated and maintained in accordance with these instructions.

© Decs Int. - 2006

We reserve the right to change the design and specifications.

Safety instructions

Operation

Installation, programming and setting up should be done by a service technician or other authorized person. For safety reasons, never remove the housing.

Do not use the "CAFITESSE 60" dispenser for any other purpose than the purpose for which it was intended. The dispenser is intended for indoor use only, at an ambient temperature of between min. +1 °C (33.8 °F) and max. +32 °C (89.6 °F).

Do not position the dispenser too close to a drain (damp) or cooking equipment (heat). Ensure that the dispenser is not stored in places where the surrounding temperature is lower than +1 °C (33.8 °F). If the dispenser is nevertheless frozen, disconnect the power and the water supply and call the service technician.

Warning



The liquids that are dispensed by the dispenser are hot. To prevent burns to the hands and other parts of the body, they should be kept away from the beverage outlet after pressing a selection button.

Do not leave children unattended near the dispenser.

The capacity of the drip tray is limited to approx. 1000 ml (1 decanter). You must empty the drip tray regularly. Also empty the drip tray if coffee, a drink or water has been dispensed without there being a cup or decanter in position.

Turn the dispenser off at the power switch when it will not be used for an extended period (for example, at night or at the weekend). Unplug the power cord only if there is a malfunction. When the power cord is not plugged in to a power outlet, the cooling system does not operate and the ingredients will not be cooled. In this case, place the ingredient packs in the refrigerator.

For hygienic and functional reasons, clean the dispenser *daily in accordance with the manual cleaning procedure and use the automatic cleaning procedure for periodic cleaning*; see the description in this manual.

Always observe basic hygiene. Use only food-grade cleaning agents for the coffee dispenser. Clean the dispenser parts with a clean, damp cloth. Do not spray or splash the equipment with water and never submerge it in water.

Make sure that there is sufficient space around the dispenser for ventilation and keep the front and back accessible for repair purposes. The dispenser may tilt a maximum of 5°.

Read the instructions in the appropriate chapter first (see the table of contents) before moving the dispenser.

For dispensers with a fixed water connection:

Connect the equipment to a manually operated tap. Use the connecting hose supplied.

Warning: Never connect the dispenser to a source that supplies polluted or biologically contaminated water. If a water filter is included, it is exclusively intended for the elimination of undesired flavours and aromatic substances (such as chlorine).



For dispensers without a fixed connection:

Warning: Use only fresh, clean drinking water to (re)fill the water tank. For the best water quality, you should fill the cold water tank with fresh tap water each morning.



Storing the ingredient packs

Ensure that the dispenser cooling compartment is properly closed at all times. If it is not, the quality of the coffee or drink can degrade.

Store defrosted coffee and ingredient pack in the refrigerator only at a temperature of 6 °C (42.8 °F).

Always check the expiration date on the coffee or ingredient pack ("use by") and use the coffee or ingredient pack that has been in storage the longest. Write the placement date on the pack before you place the pack in the dispenser.

Do not refreeze the coffee or ingredient packs again after they have thawed out. This will have a detrimental effect on the quality and the taste.

Electricity

Warning: Ensure that the power cord and the dispenser are never submerged in water or any other liquid.



Warning: Never insert the power cord plug into the power outlet (or remove it) if either the plug or the power outlet is wet or has been touched with wet hands.



Warning: Never switch on a dispenser if the power cord or power plug is damaged. The power cord may only be replaced by a service technician or other authorized personnel.



Warning: Never connect the dispenser to a power outlet with characteristics other than those indicated on the label.



Warning: Because of the risk of fire and electric shock only replace the power cord with an original power cord as provided by the equipment manufacturer. As the part number of the power cord may differ per country, contact your Cafitesse system supplier for the correct part or part number.



Connect the dispenser to a grounded circuit only. The dispenser must be connected to an electrical circuit with an extra protection or preferably a circuit with a ground leak switch.

When the dispenser is moved, ensure that the capacity of the electrical installation is not exceeded when the plug is inserted in the power outlet at the new location.

Description of the dispenser “CAFITESSE 60”

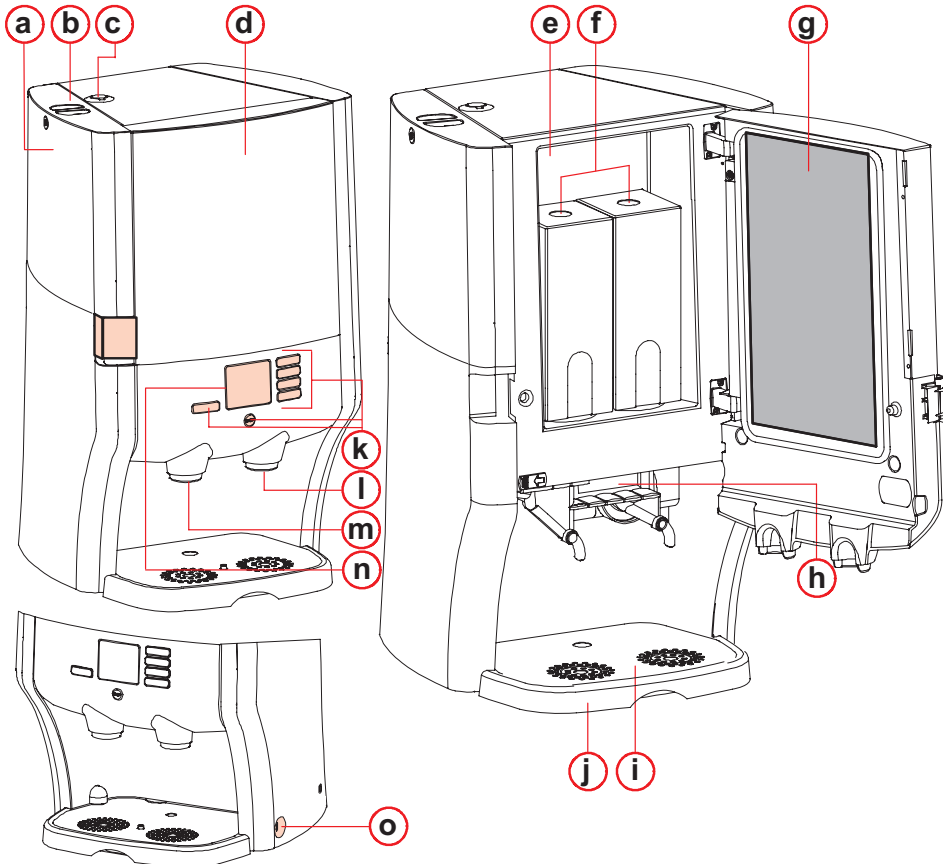
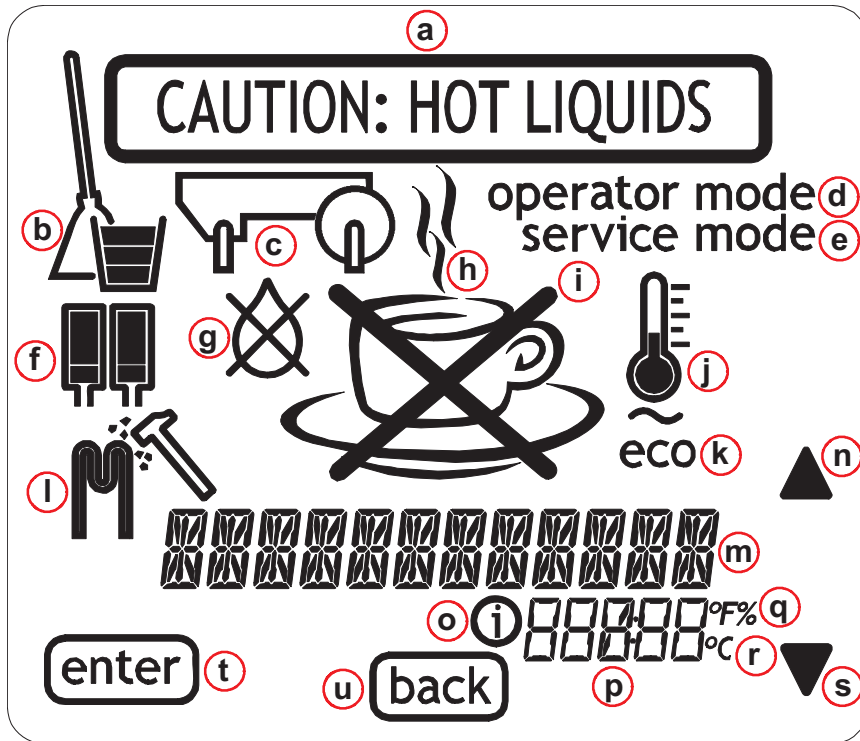

Fig. 1 Important parts

- a. Removable water tank*
- b. Cover, water tank*
- c. Descaling opening
- d. Door
- e. Cooling compartment
- f. Ingredient packs
- g. Cleaning sticker
- h. Trough
- i. Drip grid
- j. Drip tray
- k. Operating panel
- l. Beverage outlet
- m. Hot water outlet**
- n. Display
- o. Power switch (touch control)

*) Only on model with removable water tank.

**) Optional for the Cafitesse 61
Also cold water outlet if connected to a cold or extra tap water system.



Display pictograms

- a. Caution, hot drink is dosed
- b. Cleaning
- c. Trough
- d. Operator mode
- e. Service mode
- f. Ingredient packs, left and right
- g. No water
- h. Steaming cup, select drink
- i. Crossed out cup, you can't select a drink
- j. Thermometer, boiler temperature
- k. Eco (energy saving mode)
- l. Descaling pictogram, descaling program
- m. Text
- n. Scroll button (navigation/selection)
- o. Info
- p. Numeric specification
- q. Degrees Fahrenheit/percentage
- r. Degrees Celsius
- s. Scroll button (navigate/selection)
- t. Enter button (back/confirm)
- u. Back button (back/cancel)

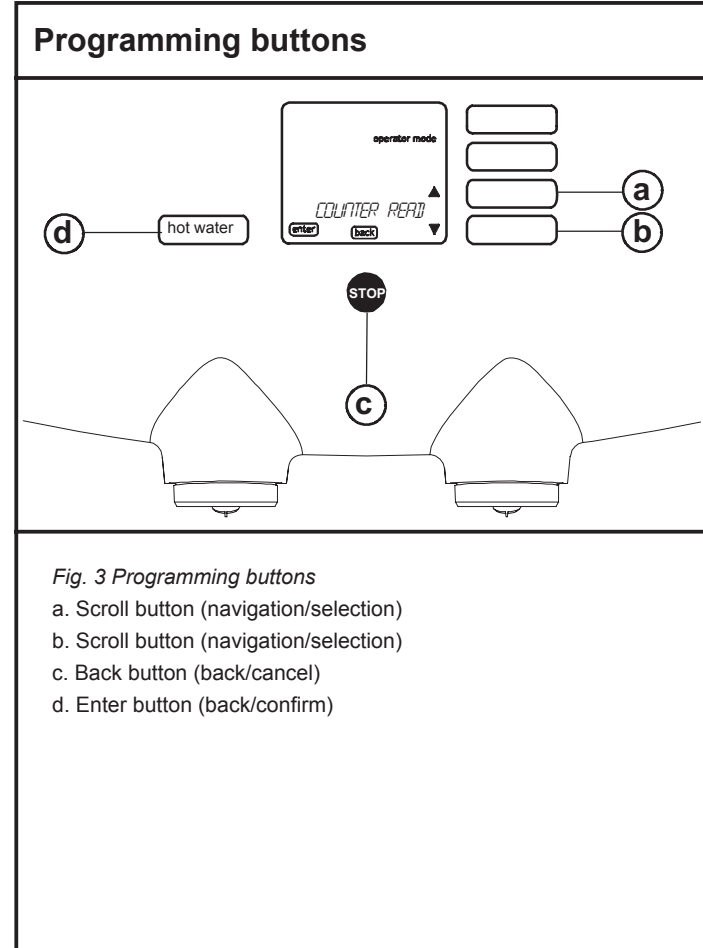
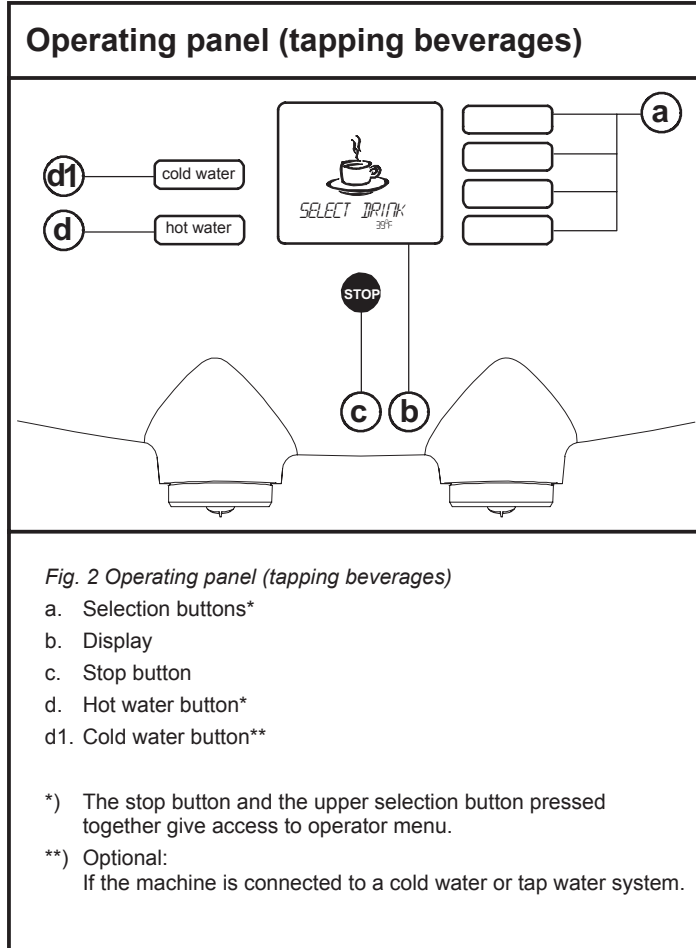

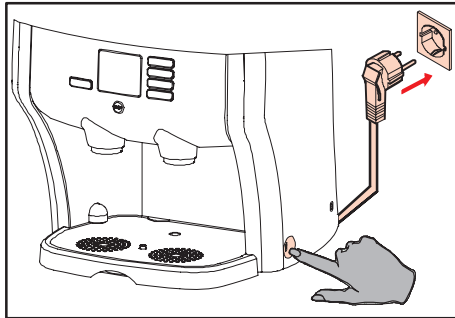

Fig. 4 Plug + switch

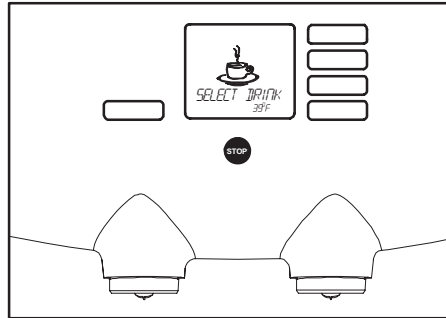

Fig. 5 Dispenser ready for use

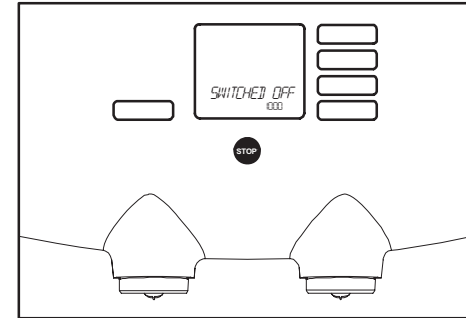

Fig. 6 Dispenser switched off

Operation of the dispenser



Caution!

- Never remove the plug from the power outlet to turn the dispenser off!
- The cooling system can not operate without power, allowing the quality of the ingredients to degrade.

Switching on the dispenser

1. Insert the plug into the power outlet.
2. Press the power switch (fig. 4).
 - The water in the boiler is heated.
 - A flashing thermometer shows in the display and the message "PLEASE WAIT".
 - When the water has reached the set temperature, a coffee cup shows in the display with the message "SELECT DRINK" (fig. 5).

The dispenser is now ready for use.

Switching off the dispenser

1. Press the power switch (fig. 4).
 - The boiler is now switched off.
 - The cooling system remains in operation.
 - The display shows the message: "SWITCHED OFF" (fig. 6).

The cooling system is only switched off when the plug is removed from the power outlet.



Fig. 7 Filling the water tank

Filling the water tank

The model without a fixed water connection is equipped with a removable water tank.

When the "NO WATER" symbol (fig. 7) shows in the display, the water tank (fig. 8 a) must be filled:

1. Remove the lid (fig. 8 b).
2. Lift the water tank by the mounting from the dispenser (fig. 8 c).

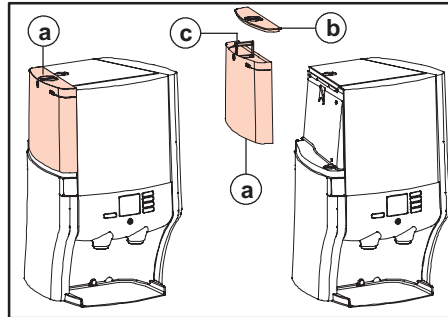

Fig. 8 Water tank model

3. Empty the water tank, rinse it and fill it with clean, fresh drinking water to the "max." mark.
 - You should fill the water tank with fresh water each day to maintain the best water quality.
4. Replace the water tank and lid.

The dispenser is now ready for use.

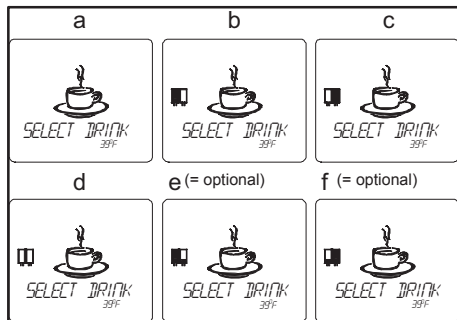

Fig. 9 Indication in the display

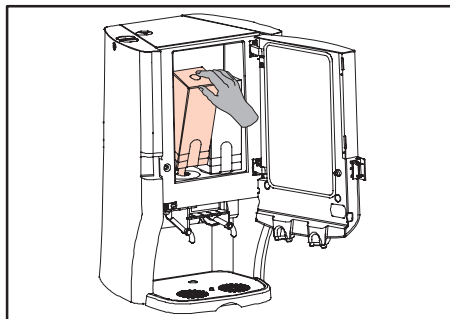

Fig. 10 Replace ingredient packs

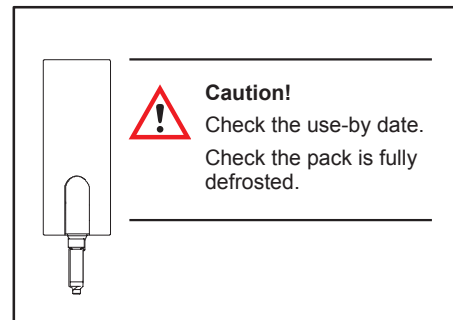

Fig. 11 Pay attention to the use-by date!

Placing/replace ingredient pack

The dispenser shows a symbol in the display when an ingredient pack is empty. Place/replace the pack when the “pack empty” symbol (fig. 9 b, c or d) shows in the display. (See also § “Display messages and troubleshooting” for more information).

Optional:

The dispenser shows a symbol (fig. 9 e or f) in the display when an ingredient pack is almost empty and the “ALMOST EMPTY” warning is set, see fig. 66. Place a new pack in the refrigerator to defrost, when the “ALMOST EMPTY” symbol shows. So the pack will be ready for exchange, when it is completely empty.

If the AED is active the dispenser asks, during placing the ingredient packs, if it is a new pack, and (optional) if it is a small one.

1. Open the cooling compartment door.
2. Lift the empty pack out of the dispenser (fig. 10)
 - Be careful of splashes, drops can come out of the dispensing spout.
3. Throw away the empty pack.
4. Clean the interior of the cooling compartment with a clean, damp cloth.
5. Always check the use-by date on the new pack.
 - Never use a pack whose use-by date has expired.
 - **Always use the pack that has been in storage the longest.**
6. Follow the instructions on the pack.
 - a. Shake the pack at least 10 times.
 - b. Check whether the pack is fully defrosted.
 - c. Fold open the dispensing spout.
7. Place the new ingredient pack in the cooling compartment. Ensure that the dispensing spout is properly positioned through the hole in the cooling compartment!
 - When the “ALMOST EMPTY” warning is set the display shows: “NEW PACK”?
8. Do nothing if the former pack is replaced, e.g. during cleaning.
9. Press the enter button to confirm if a new pack is placed.
 - When also the option “small pack” is set, the display shows: “SMALL PACK”?
10. Do nothing if a large pack is placed.
11. Press the enter button to confirm if a small pack is placed.
12. Close the cooling compartment door.

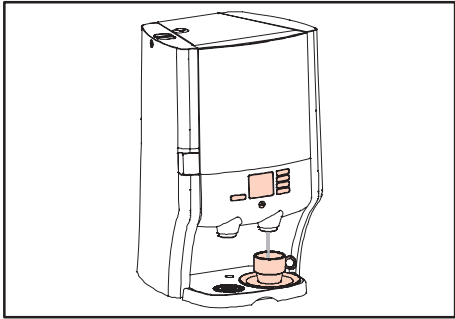

Fig. 12 Place a cup under the outlet

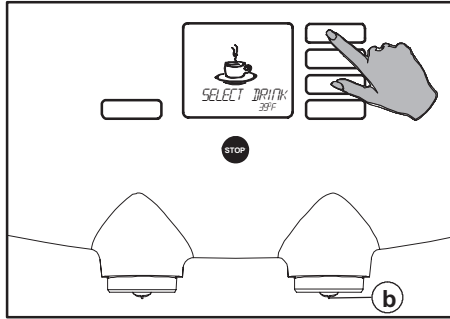

Fig. 13 Select the desired drink

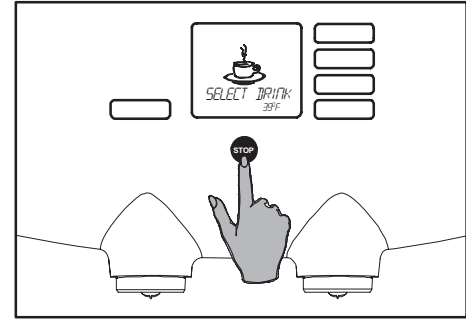

Fig. 14 Stop button

Dispensing a cup of drink

1. Place a cup on the drip grid under the right-hand outlet (fig. 12).



Caution!

- Liquids from the dispenser are hot. Avoid burns!
- Use the dispenser only when the trough has been installed correctly. When the dispenser is used without the trough, the hot water can splash around.

2. Press one of the right-hand selection buttons (fig. 13). (Not on the pot button, if present).
 - Now the dispenser dispenses the drink from the right-hand outlet (fig. 13 b) and stops automatically after one cup has been dispensed.
3. Press the stop button (fig. 14) to stop dispensing earlier, for example if you want the cup to be less full.
 - The stop button can be pressed at any time to stop dispensing (fig. 14).

If the selection button has been programmed for continuous dispensing:

(Please note, this option doesn't function with mixed drinks, e.g. cappuccino.)

4. Keep the selection button pressed until you have obtained the desired quantity of drink.
5. Release the button when you have obtained the desired quantity.

The supplier can change this setting on request.

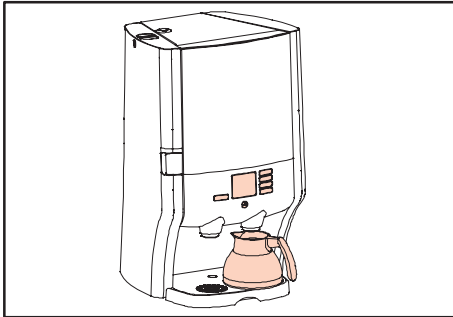

Fig. 15 Place a pot under the outlet

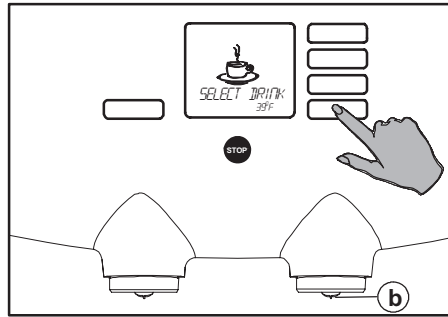

Fig. 16 Select the pot button

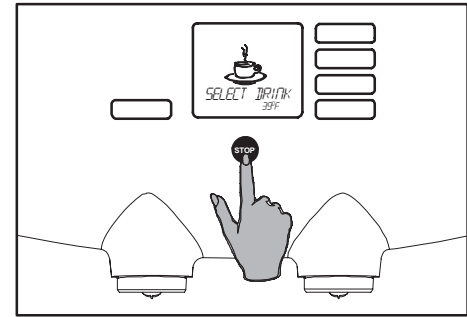

Fig. 17 Stop button

Dispensing a pot of drink

1. Place a pot under the right-hand outlet (fig. 15).
 - Use only the accompanying 0.9 liter coffee pot (1 pot is supplied with the dispenser).

2. Press the selection button for a pot of drink (fig. 16).
 - Now the dispenser dispenses the drink from the right-hand outlet (fig. 16 b) and stops automatically after one pot has been dispensed.

3. Press the stop button to stop dispensing earlier, for example if you want the pot to be less full (fig. 17).
 - The stop button can be pressed at any time to stop dispensing (fig. 17).

The supplier can change the standard pot setting on request.



Caution!

- Liquids from the dispenser are hot. Avoid burns!

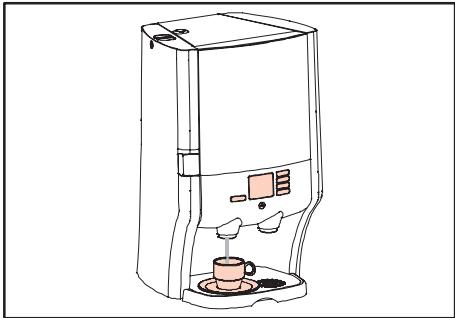

Fig. 18 Hot water outlet

Dispensing hot water*

1. Place a cup on the drip grid under the left-hand (hot water) outlet (fig. 18).



Caution!

- Liquids from the dispenser are hot. Avoid burns!

*) Optional:

If the machine is connected to a cold water or extra tap water system, cold water can be dispensed likewise by pushing the cold water button.

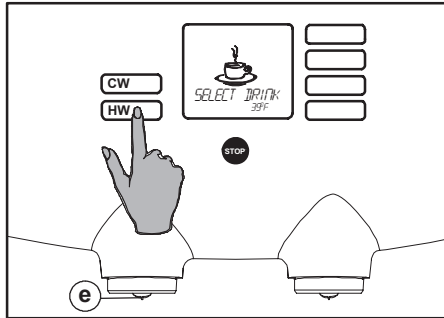

Fig. 19 Hot water button/Cold water button*

2. Press the selection button for hot water (fig. 19).
 - Now the dispenser dispenses hot water from the left-hand outlet (fig. 19 e) and stops automatically after one cup has been dispensed.
3. Press the stop button (fig. 20) to stop dispensing earlier, for example if you want the cup to be less full.
 - The stop button can be pressed at any time to stop dispensing (fig. 20).

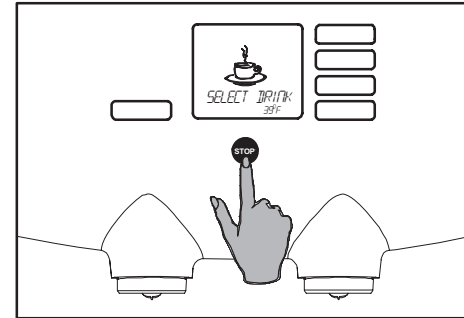

Fig. 20 Stop button

If the selection button has been programmed for continuous dispensing:**

4. Keep the selection button pressed until the desired quantity of hot water has been dispensed (fig. 19).
5. Release the button when you have obtained the desired quantity.

The supplier can change this setting on request.

***) Continuous dispensing is not possible with the cold water option, it is only possible with tap water.

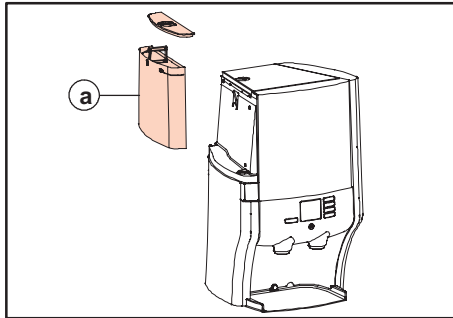

Fig. 21 Water tank

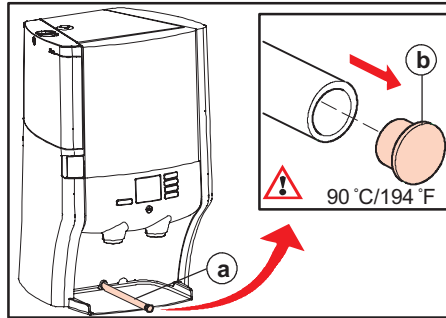

Fig. 22 Drain hose

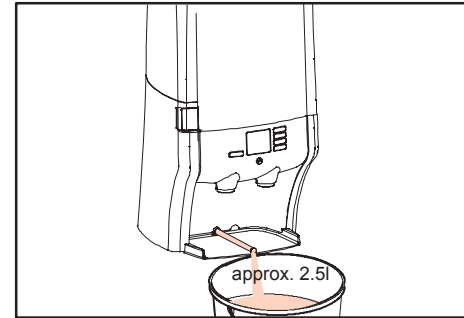

Fig. 23 Draining

Moving the dispenser with water tank



Caution!

- You may only move the dispenser when you have disconnected the power cord from the power supply.
- The boiler contains hot water, that can come out of the dispenser when you tilt it, lift it up or move it.
- The drained water can be hot. Wear protective gloves.
- Contact the service provider for moving the model with a fixed water connection!

Preparation

1. Switch the dispenser off.
2. Remove the plug from the power outlet.
3. Remove the ingredient packs from the dispenser and place them in the refrigerator.
4. Remove and empty the water tank (fig. 21 a).
5. Using the drain hose, drain all the water from the dispenser (fig. 22 a):
 - a. Remove the drip tray with grid.
 - b. Pull the drain hose approx. 12 in. (30 cm) out of the rear wall (fig. 22 a).
 - c. Slide the unit to the edge of the surface on which it is positioned.

- d. Place a container with a capacity of at least 2.5 liter under the drain hose (fig. 23).
 - e. Remove the cap (fig. 22 b) from the drain hose and allow the water to flow into the container (fig. 23).
 - f. Replace the cap on the drain hose and push the hose all the way back.
6. Clean the dispenser with a clean, damp cloth; especially around the left and right-hand outlets.

The dispenser can now be moved.

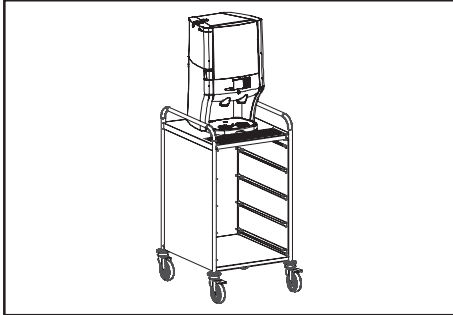

Fig. 24 Moving on a serving trolley

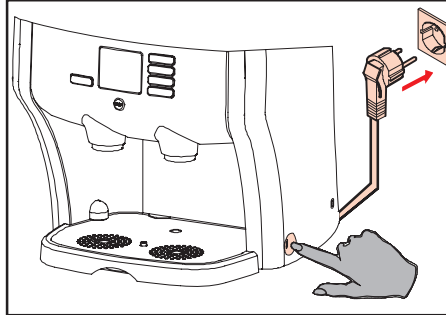

Fig. 25 Plug + switch

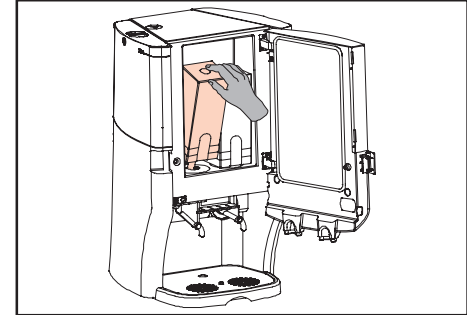

Fig. 26 Place ingredient packs



Caution!

- You may only move the dispenser when you have disconnected the power cord from the power supply.
- Always use a serving trolley or something similar to move the dispenser (26.5 kg).
- Move the trolley carefully to avoid sudden movements, bumps or shocks that might risk the dispenser to tilt or fall from the trolley.
- Never use the dispenser on a server trolley as a mobile station to dispense hot drinks.

- When installing the dispenser on the new location, ensure the placement complies with the safety instructions on page 2. Make sure that there is sufficient space around the dispenser for ventilation.
- Ensure that the dispenser does not overload the local electrical installation.

Moving the dispenser

1. Lift the dispenser carefully onto a serving trolley or something similar to move the dispenser.
2. Keep the dispenser upright and do not shake it while moving it.

3. Position the dispenser on a smooth, horizontal and stable surface that can support the weight of the dispenser (26.5 kg).
4. Position the drip tray and grid in front of the unit.
5. Insert the plug into the power outlet (fig. 25).
6. Switch the dispenser on at the power switch (fig. 25).
7. Place the ingredient packs (fig. 26).
8. Fill the water tank with clean, fresh drinking water.

The dispenser is now ready for use.

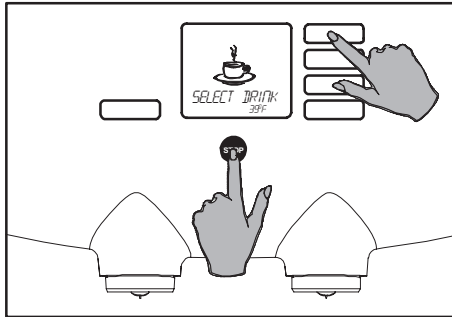

Fig. 27 Access to the operator menu

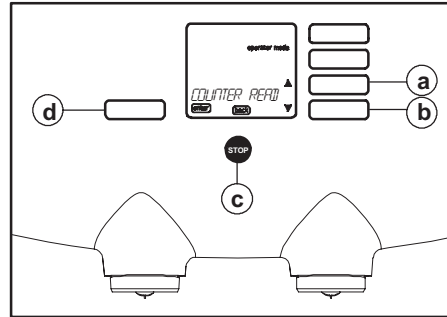

Fig. 28 Program buttons

Access to the operator menu

The dispenser has an **operator menu** in which you can perform a number of special tasks:

- Counter readings
- Cleaning (automatic, periodic cleaning procedure)
- Changing the settings such as:
 - clock setting (date and time)
 - language (in display)
 - text (on or off)
 - almost empty (AED on/AED off)
 - adjust volume (volume per cup) (optional)
 - adjust strength (optional)
- Descaling (optional)
- Service mode (optional, only for service)

The operator menu leads you through the programming step by step. The display shows a message and/or instruction to tell you what actions must/can be performed.

To activate the operator menu:

1. Keep the stop button pressed;
2. Now press the topmost selection button too (fig. 27);
3. Keep both buttons pressed until "OPERATOR MODE" appears at the top right-hand of the display;
4. Release the buttons.

In the operator menu, the selection buttons become programming buttons (fig. 28).

- Enter button (fig. 28 d), to confirm your selections.
- Scroll buttons \updownarrow (fig. 28 a and b) (navigation/selection), to page through the menu and select options.
- Stop button (back) (fig. 28 c), to cancel your changes and go back one level in the menu and to exit the operator mode.

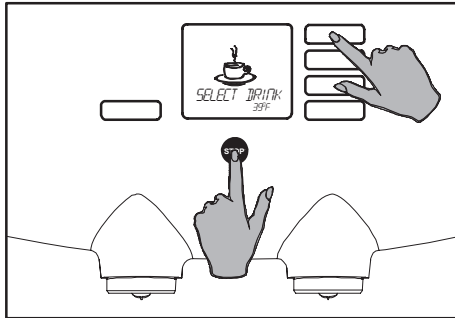

Fig. 29 Access to the operator menu

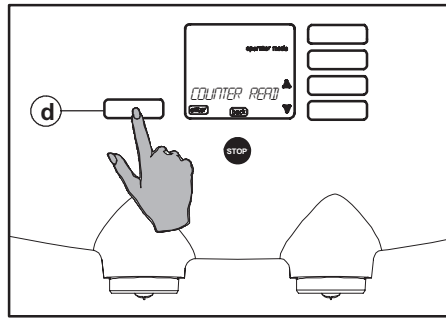

Fig. 30 "COUNTER READ" selection menu

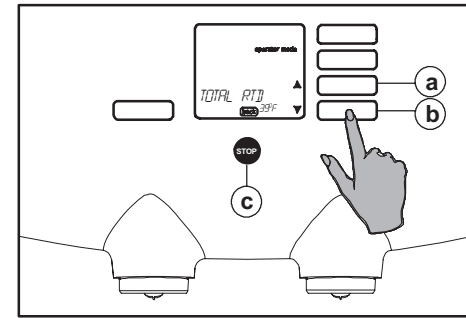

Fig. 31 Total counter

Counter readings consumptions*

In the operator menu, from the "COUNTER READ" selection menu, you can read out various counters. Some of those counters can also be reset.

ONLY READING OUT:

- "TOTAL RTD" (Ready To Drink):
Total volume in liters of all consumptions (coffee and hot water);
- "TOTAL CON L":
Total amount of liters ingredient from the left ingredient pack;
- "TOTAL CON R":
Total amount of liters ingredient from the right ingredient pack.

*) Optional

If the machine is connected to a cold water or extra tap water system, cold water consumptions can be read out/resetted too.

READING OUT AND RESETTING:

- "TOTAL FILTER":
Total amount of liters water passed through the water filter (option);
- "BUTTON 1 (2, 3 or 4) POR":
Amount of consumptions (portions) measured by selection button 1, 2, 3 or 4.
- "BUTTON 1 (2, 3 or 4) RTD":
Total volume in liters of all consumptions measured by selection button 1, 2, 3 or 4.
- "HOTWATER POR":
Amount of consumptions measured by the hot water button;
- "HOTWATER RTD":
Total volume in liters of consumptions measured by the hot water button;
- "C.WATER POR":*
Amount of consumptions measured by the cold water button;
- "C.WATER RTD":*
Total volume in liters of consumptions measured by the cold water button.

READING OUT AND RESETTING THE COUNTERS:

1. Activate the operator menu (fig. 29), see also § "Access to the operator menu" (fig. 27).
 - The display shows: operator mode "COUNTER READ", scroll arrows ▲, ▼, enter and back (fig. 28).
2. Press the enter button (fig. 30 d). The display shows the total counter "TOTAL RTD" (fig. 31).

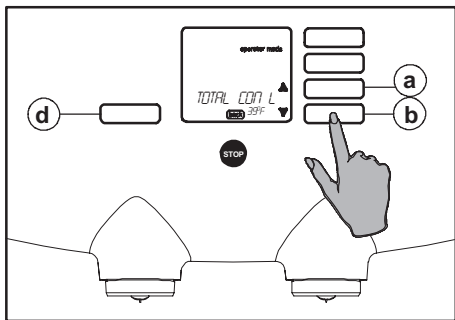

Fig. 32 Selection/reading out counter

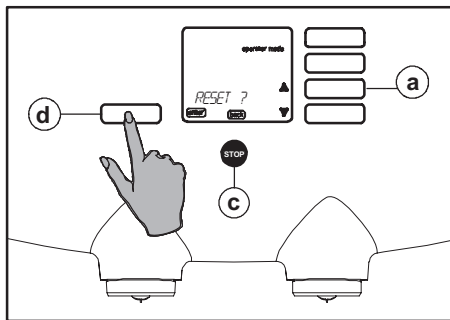

Fig. 33 Resetting counter

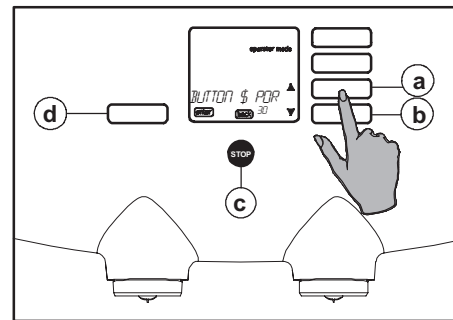

Fig. 34 Counter button 1 POR(tions)

3. Press the scroll button ▼ (fig. 32 b). The display shows the total counter for the left ingredient: "TOTAL CON L".
4. Press the scroll button ▼ (fig. 32 b) again. The display shows the total counter for the right ingredient: "TOTAL CON R".
5. Press the scroll button ▼ (fig. 32 b) again. The display shows the total counter for the water filter (optional!) "TOTAL FILTER".
 - Reset the counter, for instance when a new water filter is installed.
6. Press the enter button (fig. 32 d) to reset the counter. The display shows: "RESET ?" (fig. 33).
7. Press the **stop button** (fig. 33 c) if the counter must **not** be reset.
8. Press the **enter button** (fig. 33 d) if the counter **must** be reset.
 - The display shows the selection menu again, where you can select various counters.
9. Use with the scroll buttons ▲ (fig. 34 a or b) the counter of the desired selection button.
 - "BUTTON 1 (2, 3 or 4) POR or RTD";
 - "HOTWATER POR or RTD";
 - "C.WATER POR or RTD".*
10. Press the enter button (fig. 33 d) to reset the counter of the concerning selection button.
 - The display shows: "RESET ?".
11. Press the **stop button** if the counter must **not** be reset.
12. Press the **enter button** if the counter **must** be reset.
 - The display shows the selection menu again, where you can select various counters.
13. Repeat the previous procedure for the remaining counters.
14. Press the stop button (fig. 31 c) twice to end the programming.

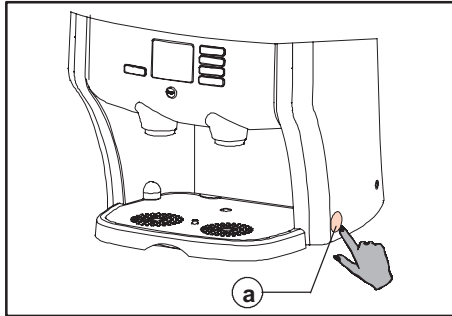

Fig. 35 Power switch

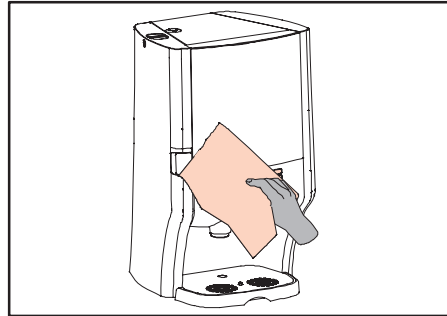

Fig. 36 Cleaning the dispenser

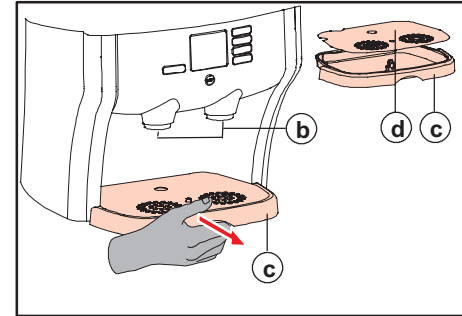

Fig. 37 Drip tray + beverage outlets

CLEANING – Manual, daily cleaning procedure

The exterior of the dispenser must be cleaned **daily** to guarantee proper and reliable operation.



Caution!

- The drip tray can contain liquid.

The drip tray, grid and trough may be cleaned in a dishwasher.

1. Switch the dispenser off by putting the power switch in the off position (fig. 35 a). The display shows: "OFF".
2. Clean the exterior of the dispenser with a clean damp cloth, possibly using a **non abrasive** and **non aggressive** cleaning agent (fig. 36).
3. Remove the drip tray (fig. 37 c).
4. Remove the grid, empty the drip tray if necessary and clean them both (fig. 37 d and c).
5. Clean the beverage outlets with a clean, damp cloth (fig. 37 b).
6. Replace the drip tray and grid in the dispenser.

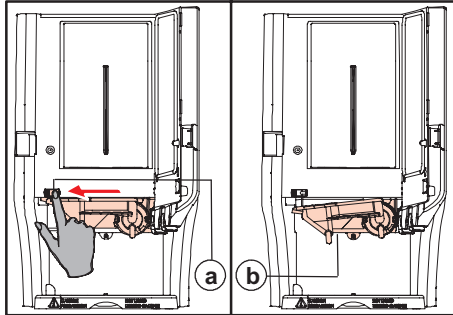

Fig. 38 Releasing trough

7. Open the door.
8. Remove the trough: release the trough by moving the red slide (fig. 38 a) to the left. The trough (fig. 38 b) comes free at the left.
9. Rotate this part further downwards, until you can pull the complete trough out of the right-hand mounting towards you (fig. 39).

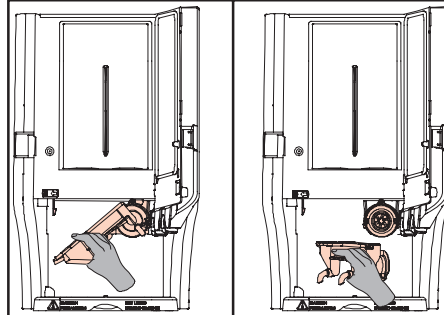

Fig. 39 Remove trough

10. Clean the trough. Remove the cover from the trough (fig. 40 a and b). The trough may be cleaned in a dishwasher.
11. Replace the cover on the trough.
12. Replace the trough in the reverse order.
13. Push the trough upwards as far as possible until it "clicks". (The flashing of the trough in the display stops).

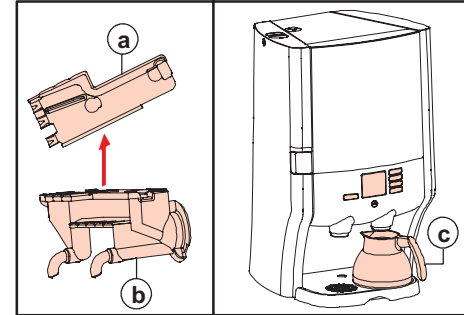

Fig. 40 Trough cover / Placing pot

14. Place a pot under the **right-hand** outlet (fig. 40 c).
 15. Switch the dispenser on by putting the power switch in the on position (fig. 35 a)
 16. Check the operation of the dispenser by pressing each selection button once.
- The dispenser is now ready for use.

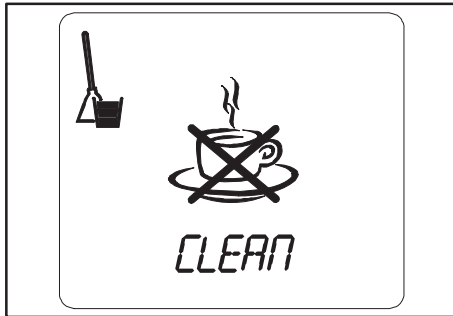

Fig. 41 Tap blocking for cleaning

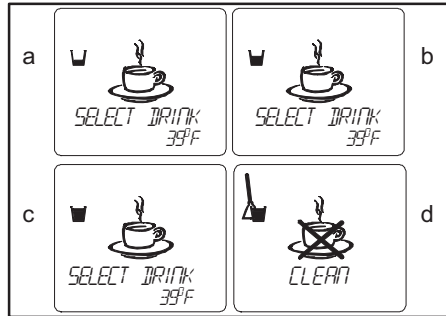

Fig. 42 Cleaning program messages

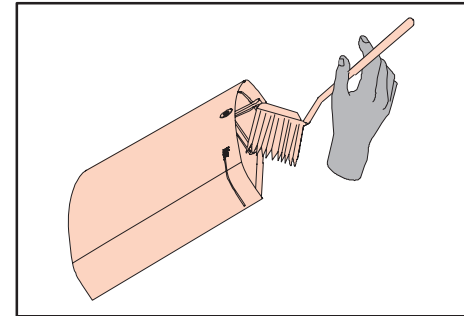

Fig. 43 Cleaning the removable water tank

CLEANING – Automatic, periodic cleaning procedure

Cleaning program

The dispenser is equipped with an automatic cleaning program. A message shows in the display when the dispenser must be cleaned.

The cleaning frequency depends on the ingredients and the associated program settings.

A bucket is shown in the display that gets fuller with each passing hour (fig. 42 a to c). This bucket indicates that the dispenser must be cleaned with the automatic cleaning program.

After the first message (fig. 42 a) you have to clean the dispenser within four hours.

Four hours after the first message the dispenser is deactivated (fig. 41) and the cleaning program **must** be started.

Of course you can always clean the dispenser in between, without the cleaning message showing.

Cleaning the model with a removable water tank:

First clean the water tank before starting the automatic cleaning program.

1. Clean the inside of the water tank with a brush (fig. 43) and a food-grade cleaning agent (e.g. Cleaner).
2. Rinse the water tank with clean water.
3. Refill the water tank (ensure that the water does not go above the max. level) and place it back in the dispenser.

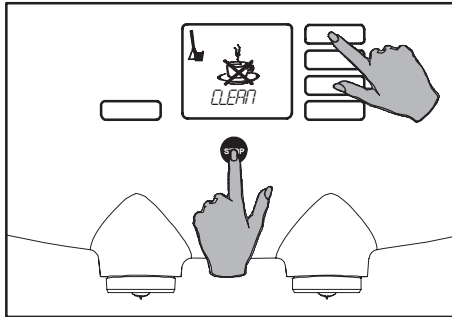

Fig. 44 Access to the operator menu

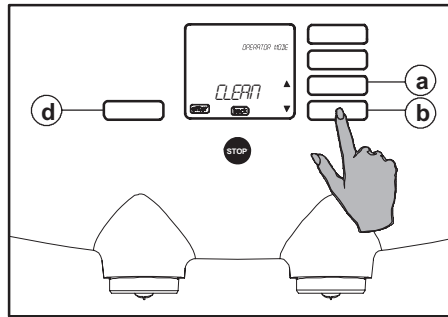

Fig. 45 Cleaning program

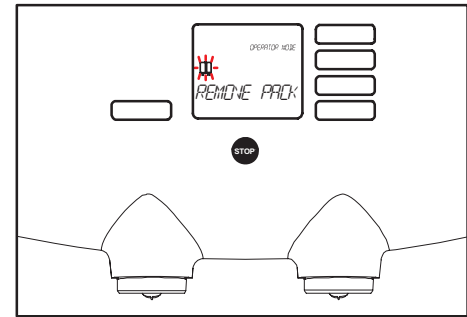





Fig. 46 Remove pack

Start the cleaning program

1. Activate the operator menu whenever the cleaning message shows in the display (fig. 44).
 - The display shows: operator mode, "COUNTER READ", scroll arrows , enter and back (fig. 28).

2. Press the scroll button  (fig. 45 b).
3. The selection menu in the display shows: "CLEAN" (fig. 45).
4. Press the enter button (fig. 45 d).
 - The display shows: "START CLEAN".
5. Press the enter button once again (fig. 45 d). The cleaning program now starts.

6. Now follow the instructions on the display:
 - The display shows: "REMOVE PACK" +  (fig. 46).
7. Open the door and remove the ingredient packs. The flashing packs disappear from the display.
8. The display shows: "CLEAN INSIDE".

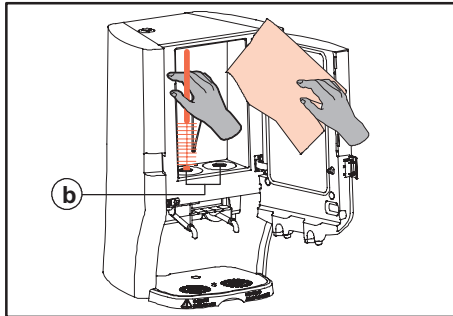

Fig. 47 Clean the round openings

9. Clean the interior of the cooling compartment with a clean damp cloth (fig. 47).
10. Clean the openings in the floor of the cooling compartment with clean warm water using the special brush supplied (fig. 47 b).

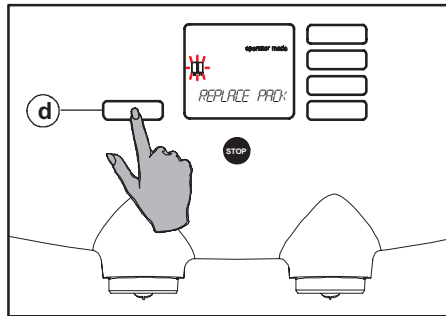



Fig. 48 Replace pack

11. Press the enter button (fig. 48 d). The display shows:
"REPLACE PACK" + .
12. Replace both ingredient packs in the correct position. The flashing stops. (When using just one ingredient pack, the flashing stops approx. 5 seconds after replacement. Then the program continues.)

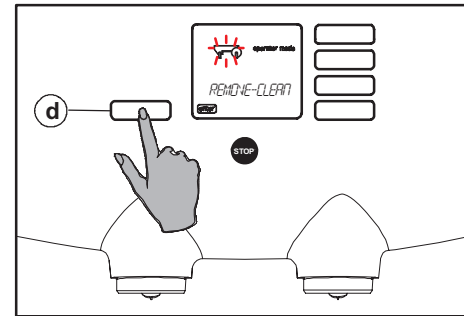



Fig. 49 Remove trough

13. The display now shows:
"REMOVE-CLEAN" +  (fig. 49)

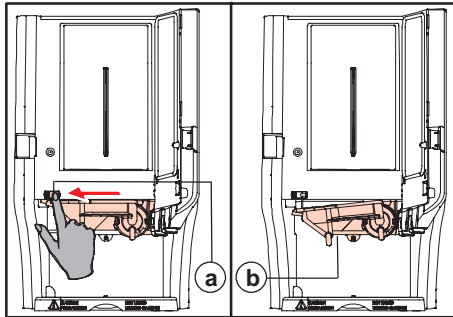

Fig. 50 Releasing trough

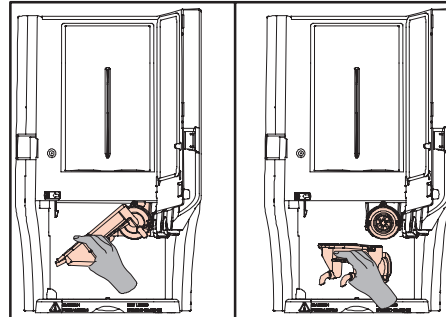

Fig. 51 Remove trough

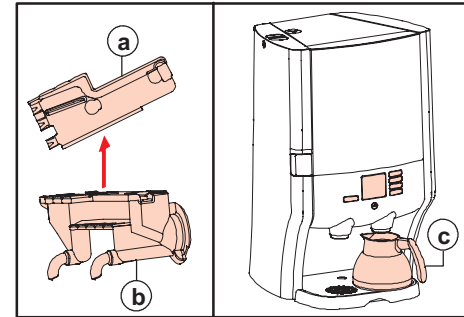

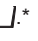



Fig. 52 Trough cover / Placing pot

14. Remove the trough: release the trough by moving the red slide (fig. 50 a) to the left. The trough (fig. 50 b) comes free at the left.
15. Rotate this part further downwards, until you can pull the complete trough out of the right-hand mounting towards you (fig. 51). The trough disappears from the display.
16. Clean the trough. Remove the cover from the trough (fig. 52 a and b). The trough may be cleaned in a dishwasher.
17. The display shows: "REPLACE" + .
18. Replace the cover on the trough.
19. Replace the trough in the reverse order.

20. Push the trough upwards as far as possible until it "clicks". The flashing of the trough in the display stops.
21. The display shows: "PLACE RIGHT" + . Press the enter button (fig. 48 d).
22. Position an empty pot (fig. 52 c) underneath the **right-hand** outlet.
23. Press the enter button (fig. 48 d). The display shows: "PUSH * FLUSH".
24. Press the enter button (fig. 48 d). The display shows: "FLUSH" and a flashing "CAUTION: HOT LIQUIDS". The rinsing water flows into the pot.
25. Then empty the pot.
26. The display shows: "PLACE LEFT" + .*
27. Position an empty pot (fig. 52 c) underneath the **left-hand** outlet.

28. Press the enter button (fig. 48 d). The display shows: "PUSH * FLUSH".
 29. Press the enter button (fig. 48 d). The display shows: "FLUSH" and a flashing "CAUTION: HOT LIQUIDS". The rinsing water flows into the pot.
 30. Then empty the pot.
 31. The display shows: "SELECT DRINK" + .
 32. Check the dispenser operation by selecting one or more products.
- The dispenser is now clean and ready for use once more.

*) Optional

Points 26. till 30. only appear in the display and have to be executed if a cold water/extra tap water system is installed and activated.

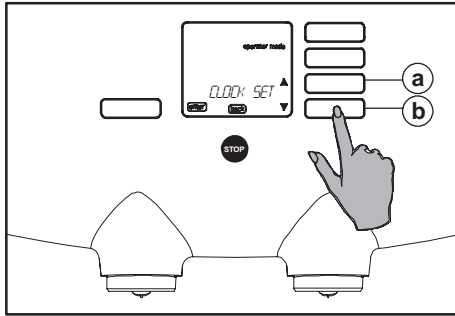

Fig. 53 Selection menu "clock set"

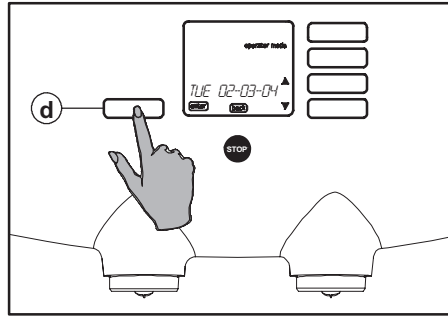

Fig. 54 Day, date and time display

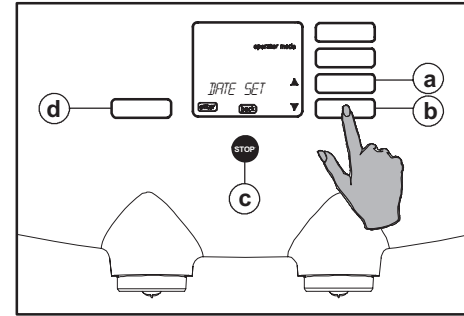

Fig. 55 Setting the date

Changing the settings

Besides the "COUNTER READ", "CLEANING" and "DESCALING", there are six other settings. The following six settings can be changed:

- "CLOCK SET": set date and time;
- "LANGUAGE": set the language;
- "TEXT": text display on or off;
- "ALMOST EMPTY": switch "ALMOST EMPTY" warning on or off;
- "ADJ VOLUME": adjust volume per cup (optional);
- "ADJ STRENGTH": adjust strength per cup (optional);

Clock setting: set date and time

In the operator menu, from the selection menu "CLOCK SET", you can set the "DATE" with day name/day/month/year and the "TIME". (The time must be adjusted, for example, at the start and end of daylight saving).

1. Activate the operator menu, see also § "Access to the operator menu" (fig. 27).
2. The display shows: operator mode, "COUNTER READ", scroll arrows \updownarrow , enter and back (fig. 28).
3. Use the scroll buttons \updownarrow (fig. 53 a or b) until the option "CLOCK SET" shows in the display.
4. Press the enter button (fig. 54 d). The display shows the day, date and time set.
5. Use the scroll buttons \updownarrow until the option "DATE SET" appears in the display (fig. 55 a or b).
6. Press the enter button (fig. 55 d). The display shows: "DAYNAME".
7. Press the enter button again (fig. 55 d).
8. Select with the scroll buttons \updownarrow (fig. 55 a or b) the correct day (Monday to Sunday).
9. Press the enter button (fig. 55 d) to confirm the setting. The display shows: "DAYNAME" again.

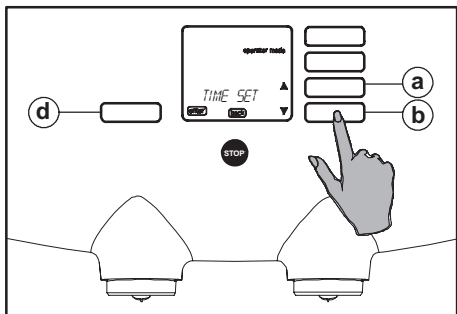

Fig. 56 Selecting the time setting

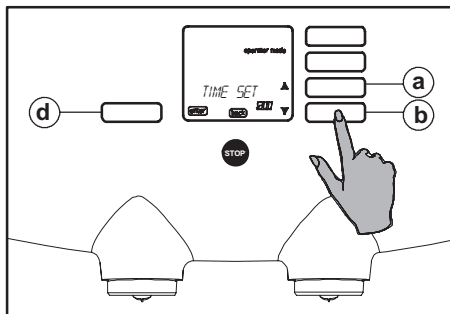

Fig. 57 Time setting

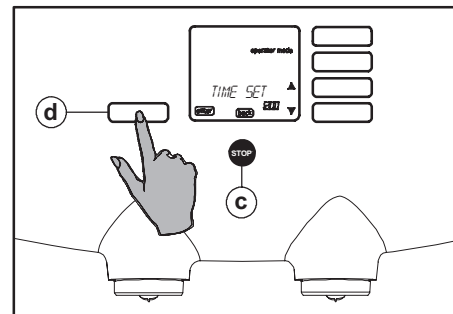

Fig. 58 Confirming the time setting

10. You can now do 2 things:

- Press the stop button 3x (fig. 55 c) to stop programming or:
- Use the scroll buttons \updownarrow (fig. 55 a or b) to select the options "DAY, MONTH or YEAR", if these must be changed too.

11. Press the enter button (fig. 55 d) and use the scroll buttons \updownarrow (fig. 55 a or b) to change the day (1-31), the month (1-12) or the year.

12. Press the enter button (fig. 55 d) to confirm the setting.

13. Now press the stop button 1x (fig. 55 c) if you also want to change the "TIME" or 3x to stop programming.

14. After pressing the stop button 1x, the display shows: "DATE SET" (fig. 55 c).

15. With the scroll buttons \updownarrow , select the option "TIME SET", (fig. 56 a or b).

16. Press the enter button (fig. 57 d) and change the time with the scroll buttons \updownarrow (fig. 57 a or b).

17. Press the enter button (fig. 58 d) to confirm the setting.

18. Press the stop button 2x (fig. 58 c) to end the programming.

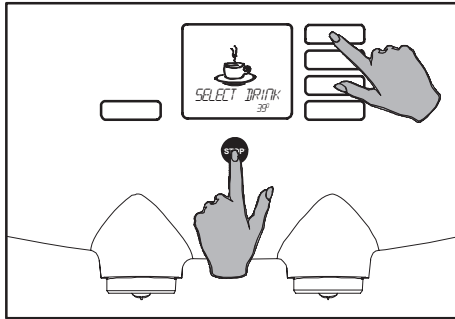

Fig. 59 Access to the operator menu

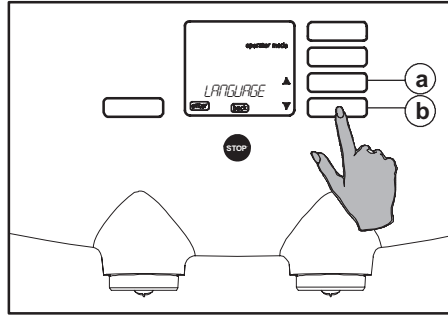

Fig. 60 "LANGUAGE" selection menu

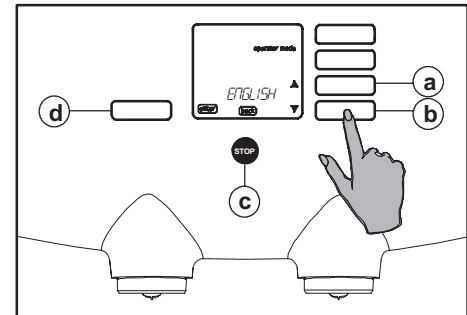

Fig. 61 Selecting the language

Language setting

You want to change the display language.

In the operator menu, from the "LANGUAGE" selection menu (fig. 60), you can choose which languages is to show in the display:

1. Activate the operator menu (fig. 59), see also § "Access to the operator menu" (fig. 27).
2. The display shows: operator mode, "COUNTER READ", scroll arrows \updownarrow , enter and back (fig. 28).
3. Use the scroll buttons \updownarrow until the option "LANGUAGE" appears in the display (fig. 60 a or b).
4. Press the enter button (fig. 61 d). The display shows the language selected.
5. With the scroll buttons \updownarrow , select the desired language (fig. 61 a or b).
6. Press the enter button (fig. 61 d) to confirm the setting.
7. Then press the stop button (fig. 61 c) to end the programming.

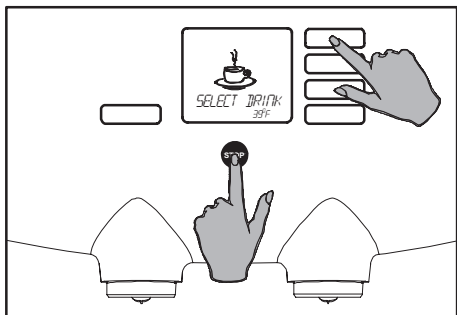

Fig. 62 Access the operator menu

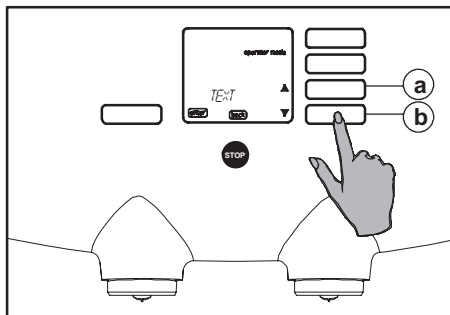

Fig. 63 "TEXT" selection menu

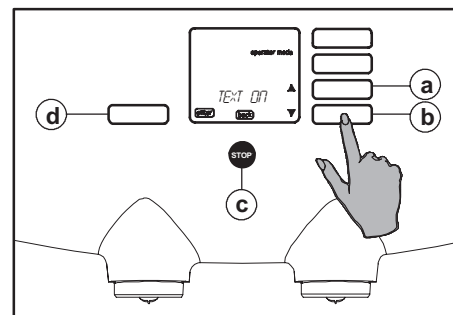

Fig. 64 Selecting "TEXT ON or OFF"

Switching text on or off

You do/don't want to see the display text.

In the operator menu, from the "TEXT" selection menu (fig. 63), you can choose whether the text "SELECT DRINK" should show in the display or not before a drink is selected.

1. Activate the operator menu (fig. 62), see also § "Access the operator menu" (fig. 27).
2. The display shows: operator mode, "COUNTER READ", scroll arrows \updownarrow , enter and back (fig. 28).
3. Use the scroll buttons \updownarrow until the option "TEXT" appears in the display (fig. 63 a or b).
4. Press the enter button (fig. 64 d). The display shows the option selected.
5. With the scroll buttons \updownarrow , choose "TEXT ON" or "TEXT OFF" (fig. 64 a or b).
6. Press the enter button (fig. 64 d) to confirm the setting.
7. Then press the stop button (fig. 64 c) to end the programming.

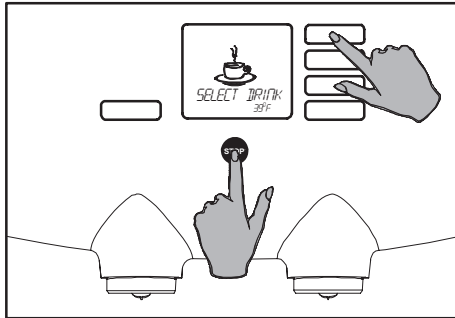

Fig. 65 Access to the operator menu

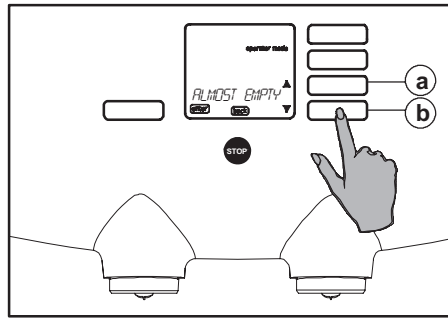

Fig. 66 "ALMOST EMPTY" selection menu

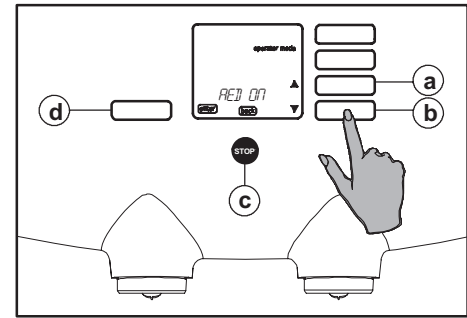



Fig. 67 Selecting "AED ON" or "AED OFF"

"Almost empty" Detection

In the operator menu, from the "ALMOST EMPTY" selection menu (fig. 66), you can set the "ALMOST EMPTY" detection.

This signal indicates that an ingredient pack is almost empty, so you can thaw out in time a new pack.

The dispenser then shows a symbol in the display when an ingredient pack is "almost empty." Place a new pack in the refrigerator to defrost, when this symbol is shown. So the pack will be ready for exchange, when it is completely empty.

1. Activate the operator menu.
2. Use the scroll buttons  until the option "ALMOST EMPTY" appears in the display (fig. 66 a or b).
3. Press the enter button (fig. 67 d). The display shows the option selected (fig. 67).
4. With the scroll buttons , choose "AED ON" or "AED OFF" (fig. 67 a or b) [AED = Almost Empty Detection].
5. Press the enter button (fig. 67 d) to confirm the setting.
6. Then press the stop button (fig. 67 c) to end the programming.

ATTENTION!

Only when the "ALMOST EMPTY" detection is set the question if it is a new pack appears in the display, while placing an ingredient pack.

1. Press the enter button to confirm if a new pack is placed.
2. Do nothing if the former pack is replaced. The question disappears automatically from the display.

If also the option "SMALL PACK" is set, the question if it is a small pack appears in the display too, after the confirmation of a new pack.

3. Press the enter button if a small pack is placed.
4. Do nothing if a large pack is placed. The question automatically disappears from the display.

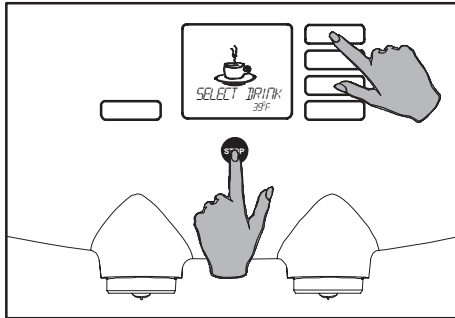

Fig. 68 Access the operator menu

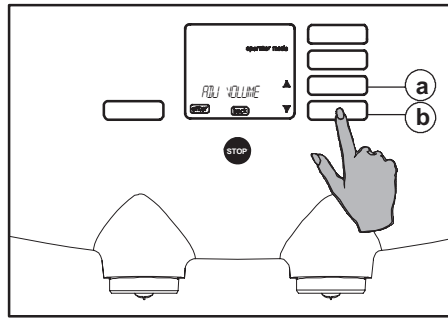

Fig. 69 Selection menu "ADJ VOLUME"

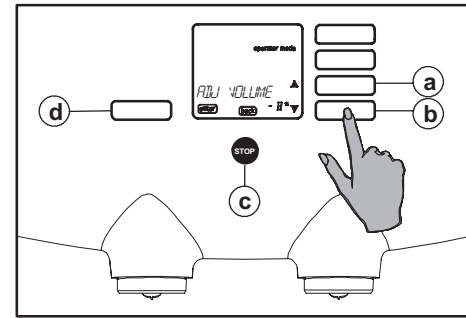

Fig. 70 Set +/- number %

Volume setting (optional)

You want to adjust the volume, for instance for an other coffee or tea set.

In the operator menu, from the "ADJ VOLUME" selection menu, you can adjust the volume per cup by increasing or decreasing the quantity of water by a maximum of 10%, in steps of 1%.



Caution!

- The volume adjustment concerns all drinks and the hot water.

1. Activate the operator menu (fig. 68), see also § "Access the operator menu" (fig. 27).
2. The display shows: operator mode, "COUNTER READ", scroll arrows \updownarrow , enter and back (fig. 28).
3. Use the scroll buttons \updownarrow (fig. 69 a or b) until the option "ADJ VOLUME" shows in the display.
4. Press the enter button (fig. 70 d). The display shows the number of percent that is set (fig. 70).
5. With the scroll buttons \updownarrow (fig. 70 a or b), select the desired volume adjustment.
6. Press the enter button (fig. 70 d) to confirm the setting.
7. Then press the stop button (fig. 70 c) to end the programming.
8. Check the quantity by dispensing a cup of drink.

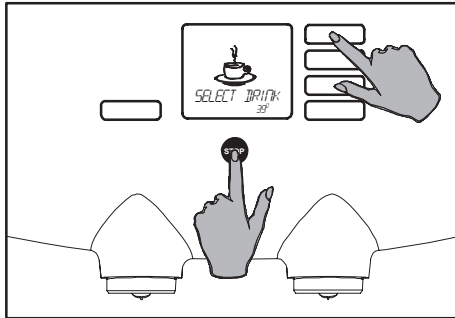

Fig. 71 Access the operator menu

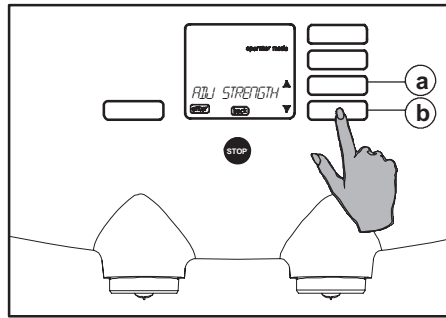

Fig. 72 Selection menu "SET STRENGTH"

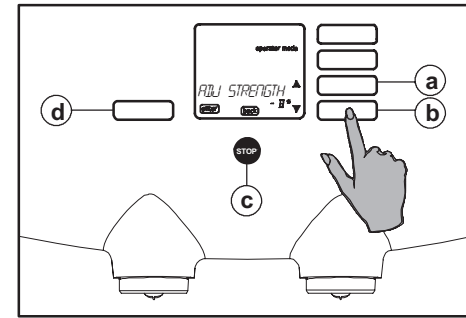

Fig. 73 Set +/- number %

Strength setting (optional)

You want a stronger or just a milder taste. In the operator menu, from the "ADJ STRENGTH" selection menu, you can adjust the strength of a cup by increasing or decreasing the quantity of ingredients with maximum 10%, in steps of 1%.



Caution!

- The strength adjustment concerns all drinks.

1. Activate the operator menu (fig. 71), see also § "Access the operator menu" (fig. 27).
2. The display shows: operator mode, "COUNTER READ", scroll arrows \updownarrow , enter and back (fig. 28).
3. Use the scroll buttons \updownarrow (fig. 72 a or b) until the option "ADJ STRENGTH" shows in the display.
4. Press the enter button (fig. 73 d). The display shows the number of percent that is set (fig. 73).
5. With the scroll buttons \updownarrow (fig. 73 a or b), select the desired strength adjustment.
6. Press the enter button (fig. 73 d) to confirm the setting.
7. Then press the stop button (fig. 73 c) to end the programming.
8. Check the strength by dispensing and taste a cup of drink.



Fig. 74 Descaling warning

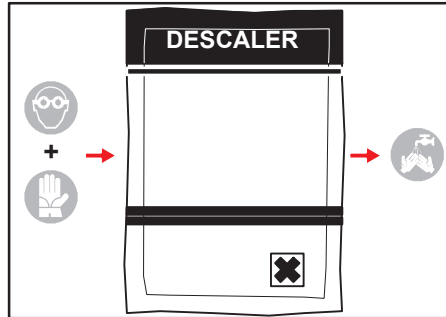

Fig. 75 Safety precautions

Descaling the dispenser

During use, scale deposits occur in the dispenser. The unit is equipped with a descaling warning system. This is activated after a specific number of liters of water have passed through the unit.

When the descaling symbol (fig. 74) is displayed this program must start shortly afterwards. Otherwise the dispenser will be deactivated after some time.

The descaling procedure lasts approx. 45 minutes.



Caution!

- Descal the dispenser as soon as possible, when the descaling pictogram is displayed.
- Before descaling the dispenser, read the operator manual and the recommendations on the sachet of the descaling agent.
- Use only descaling agents suitable for the coffee dispenser.
- Always wear suitable face protection and protective gloves when using the cleaning agent and/or descaling agent. Wash your hands after using these agents.

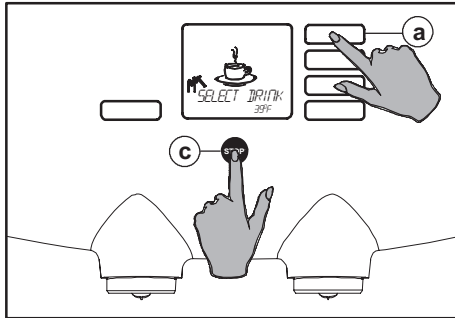

Fig. 76 Access to the operator menu

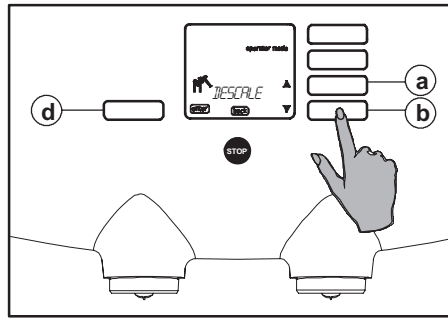

Fig. 77 Scrolling in the selection menu

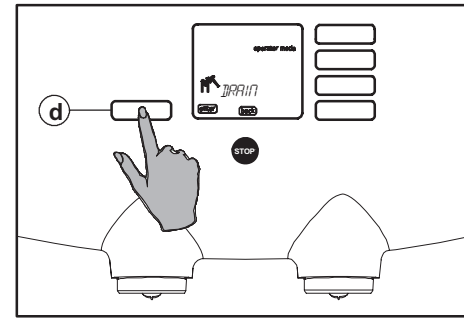

Fig. 78 Starting the descaling program

Start descaling program (Optional)

For a explanation of the terms in the display and the associated buttons, see also § "Access to the operator menu" (fig. 27).

For the **model without a fixed water connection** the removable water tank must be filled a number of times during the descaling process. Fill the tank when the "FILL TANK" symbol (fig. 84) shows in the display.

During descaling, if the bucket is in danger of overflowing, the program can be interrupted by pressing the stop button (fig. 76 c). The bucket can then be emptied. Press the stop button again to continue.

The program can not be aborted while it is running and must thus be run to completion.

1. Wear suitable face protection and protective gloves.
2. Activate the operator menu (fig. 76), see also § "Access the operator menu" (fig. 27).
3. The display shows: operator mode, "COUNTER READ", scroll arrows \updownarrow , enter and back.

4. Use the scroll buttons \updownarrow until the option "DESCALE" appears in the display (fig. 77 a or b).
5. Press the enter button (fig. 78 d). The display shows: "ARE YOU SURE?".
6. Press the enter button again (fig. 78 d). The display shows: "DRAIN" +  (fig. 78).
7. Remove the drip tray.
8. Slide the dispenser forwards slightly and place a bucket with a capacity of at least 12 liters/3.17 gallons underneath.

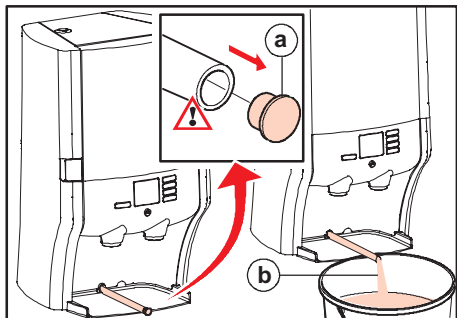



Fig. 79 Draining

9. Pull the drain hose approx. 12 inch (30 cm) out of the rear wall and put the end in the bucket (fig. 79).



Caution!

- The water coming out of the drain hose is hot!

10. Remove the cap from the drain hose and allow the hot water to flow into the bucket (fig. 79 a and b).
11. Refit the cap on the drain hose when no more water comes out of the hose (approx. 2.5 liter).
12. After draining, empty the bucket!
13. Press the enter button (fig. 78 d).
The display shows:
"REMOVE PACK" + 

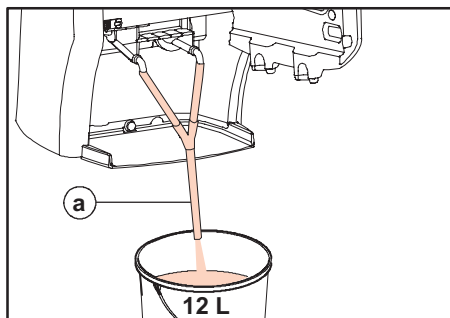

Fig. 80 Hose set on beverage outlets

14. Remove the ingredient packs and place them in a refrigerator temporarily.
 - **With the model with removable water tank, the display shows:**
"EMPTY TANK".
 - Empty the water tank and press the enter button (fig. 78 d).
15. The display shows:
"PLACE HOSE".
16. Slide the hose set supplied onto both beverage outlets (fig. 80 a).
17. Put the end of the hose in the bucket.
18. Press the enter button (fig. 78 d).
The display shows:
"0.5 L RENEGIT".
19. Dissolve 100 g Renegite in 0.5 liter warm water (40 °C / 104 °F).

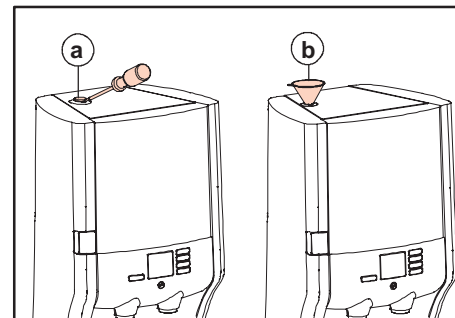



Fig. 81 Cap/funnel in descaling opening

- **With the model with a removable water tank:**
 - Carefully pour the descaling solution into the water tank and continue from step 24.
20. Using an adaptor, remove the cap from the descaling opening (fig. 81 a).
 21. Place the funnel supplied in the opening (fig. 81 b).
 22. Pour the descaling solution through the funnel into the filler opening.
 23. Remove the funnel and refit the cap to the descaling opening.
 24. Press the enter button (fig. 78 d).
The display shows: "PLEASE WAIT" + . The descaling program starts!
 25. The dispenser is descaled automatically. The rinsing water now flows through the hose set into the bucket (approx. 12 l).

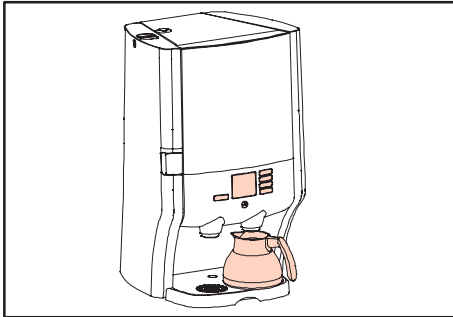

Fig. 82 Place a pot under the outlet

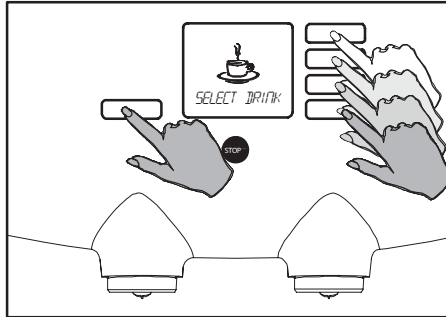

Fig. 83 Check the operation

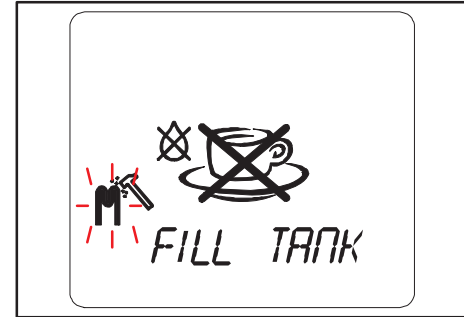

Fig. 84 Water tank empty, fill the tank





Caution!

- Press the stop button (fig. 76 d) if the bucket is in danger of overflowing!
- Empty the bucket.
- Press the stop button again to continue the descaling program.

● **With the model with a removable water tank:**

- When the "FILL TANK" symbol (fig. 84) shows in the display for the first time, flush the water tank thoroughly with warm water to remove all the descaling residue.
- Fill the tank with clean water.

- Thereafter, fill the tank whenever the "FILL TANK" symbol shows in the display.
26. When the descaling program has completed, the display shows: "DRAIN".
 27. Empty the bucket.
 28. Remove the cap from the drain hose and allow the water to flow into the bucket (fig. 79).
 29. Refit the cap on the drain hose when no more water comes out of the hose (approx. 2.5 l).
 30. Push the drain hose back into the rear wall.
 31. Press the enter button (fig. 78 d).
The display shows:
"REPLACE PACK" + .

32. Place the ingredient packs back in the cooling compartment, the display shows a cup.
33. Press the enter button again (fig. 78 d).
The display first shows:
"PLEASE WAIT" and after that .
34. The boiler will be filled with water. If the water reaches the right temperature the thermometer will disappear from the display and will show "SELECT DRINK".
35. Place a pot under the outlet (fig. 82).
36. Check the operation of the dispenser by pressing a selection button once and the hot water button once (fig. 83).
The dispenser is now ready for use again.

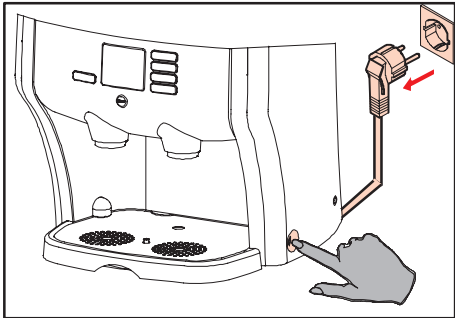

Fig. 85 Switching the dispenser off/on

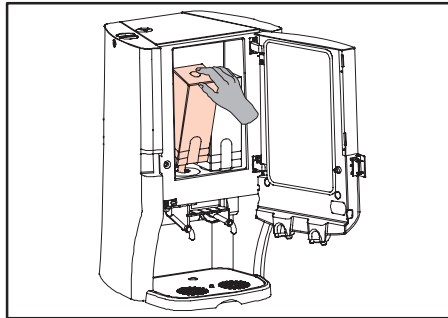

Fig. 86 Removing/replacing ingredient pack

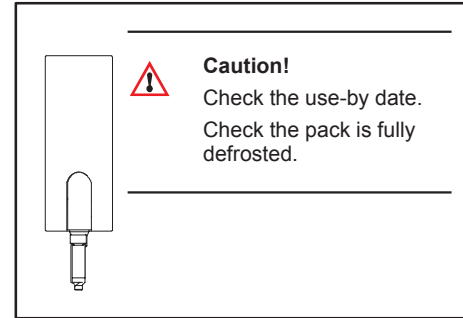

Fig. 87 Pay attention to the use-by date

Putting the dispenser into service after storage / Storing the dispenser





Carry out the following steps when you want to put the dispenser back into service after an extended period:



1. Ensure that the ingredient packs are ready in the cooling compartment.
2. Carry out the manual and automatic cleaning procedures, see § Cleaning (fig. 29).
 - Any ingredient packs that were removed earlier can be used again, provided that the use-by date has not expired. Check the use-by date.
3. Place a pot under the outlet and check the operation of the dispenser by dispensing hot water and each drink once.





Carry out the following steps when you do not want to use the dispenser or want to put it in storage for an extended period:

1. Carry out the manual and automatic cleaning procedures, see § Cleaning (fig. 35).
2. Remove the ingredient packs (fig. 86).
3. Check the use-by dates of the ingredient packs before storing them in a refrigerator (fig. 87).
4. Drain all the water out of the dispenser with the drain hose, see the section "Draining the dispenser" (fig. 22)
5. Switch the dispenser off and pull the plug out of the power outlet (fig. 85).
6. Leave the door slightly open.

Display messages and troubleshooting

Display message	Meaning	Cause	Action
	The icon “replace right-hand ingredient pack (coffee)” shows in the display.	The right-hand ingredient pack is: <ul style="list-style-type: none"> • empty; • incorrectly fitted; • or not present. 	Replace the empty ingredient pack. Check that the ingredient pack is correctly positioned and reposition it again according to the instructions on the ingredient pack.
	The icon “replace left-hand ingredient pack” shows in the display.	The left-hand ingredient pack is: <ul style="list-style-type: none"> • empty; • incorrectly fitted; • or not present. 	Replace the empty ingredient pack. Check that the pack is correctly positioned and reposition it again according to the instructions on the ingredient pack.
	The icon “replace left and right-hand ingredient pack” shows in the display.	The left and right-hand ingredient pack is: <ul style="list-style-type: none"> • empty; • incorrectly fitted; • or not present. 	Replace the empty ingredient packs. Check that the ingredient packs are correctly positioned and reposition them again according to the instructions on the coffee pack.
	Optional: The icon “right-hand (coffee) ingredient pack almost empty” shows in the display.	<i>The right-hand (coffee) pack is almost empty.</i>	<i>Place a new pack in the refrigerator to defrost.</i>
	Optional: The icon “left-hand ingredient pack almost empty” shows in the display.	<i>The left-hand ingredient pack is almost empty.</i>	<i>Place a new pack in the refrigerator to defrost.</i>

Display message	Meaning	Cause	Action
 <p data-bbox="209 436 427 504">PLEASE WAIT 39°F</p>	<p data-bbox="505 297 822 341">A flashing thermometer shows in the display.</p> <p data-bbox="505 350 766 420">When a selection button is pressed, the text "PLEASE WAIT" is also shown.</p>	<p data-bbox="848 297 1162 341">The water in the boiler is not yet at the correct temperature.</p>	<p data-bbox="1188 297 1567 341">The dispenser is deactivated until the temperature has reached the value set.</p>
 <p data-bbox="391 723 445 759">50°F</p>	<p data-bbox="505 540 802 584">A temperature value (°C of °F) shows in the display.</p>	<p data-bbox="848 540 1144 633">The temperature in the cooling compartment can not be maintained at 2 - 5 °C or 35.6 - 41 °F.</p>	<p data-bbox="1188 540 1616 584">Check that the cooling compartment door is properly closed.</p> <p data-bbox="1188 594 1616 686">Check whether the temperature of the coffee pack is considerably higher than 2 - 5 °C or 35.6 - 41 °F (also check that the pack is not frozen).</p> <p data-bbox="1188 696 1585 740">Place a properly precooled coffee pack in the cooling compartment.</p> <p data-bbox="1188 749 1603 794">Check whether there is clearance for ventilation at the rear side of the dispenser.</p> <p data-bbox="1188 803 1567 848">Remove the filter grid at the back of the dispenser and clean the filter if it is dirty.</p> <p data-bbox="1188 857 1590 901">Give the dispenser time to cool, the signal disappears then automatically.</p>
 <p data-bbox="223 1022 427 1089">OUT OF ORDER 020</p>	<p data-bbox="505 942 822 986">The icon "OUT OF ORDER" with info no. 20 shows in the display.</p>	<p data-bbox="848 942 1144 986">The water supply is blocked or the tap is not open.</p>	<p data-bbox="1188 942 1603 1032">Check the water supply and then press the power switch twice to reset the dispenser. Contact the service provider if the signal does not disappear.</p>

Display message	Meaning	Cause	Action
 <p>TROUGH ERROR</p>	The icon "TROUGH ERROR" shows in the display.	The trough is not present or is not properly latched.	Position the trough and lock it. Press the trough upward until it clicks in position.
 <p>OUT OF ORDER 043</p>	The icon "OUT OF ORDER" with an info number shows in the display.	A specific failure has occurred.	Contact the service provider. Report the info number of the failure.
 <p>CLEAN</p>	The icon "CLEAN" shows in the display.	The dispenser must be cleaned. Read the section "CLEANING - Automatic, periodic cleaning procedure" for details.	Carry out the automatic, periodic cleaning procedure.
<p>SWITCHED OFF 1000</p>	All dispenser functions except the cooling, are "SWITCHED OFF".	All dispenser functions, except the cooling, are switched off.	Switch the dispenser on at the power switch.
	The display is off.	The power supply has been interrupted.	Check the supply plug. Check the power supply (earth leak switch or fuse).

Display messages and troubleshooting when using model with *removable water tank*

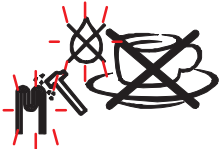
Display message	Meaning	Cause	Action
 <p>NO WATER</p>	The icon "NO WATER" shows in the display.	The water tank contains too little or no water, is incorrectly positioned or not present.	Fill the water tank with fresh water. Check that the water tank is correctly positioned
 <p>FILL TANK</p>	The icon "FILL TANK" shows in the display.	The water tank contains too little or no water, is incorrectly positioned or not present.	Fill the water tank with fresh water. Check that the water tank is correctly positioned.

Quick reference

Serve a drink and hot water

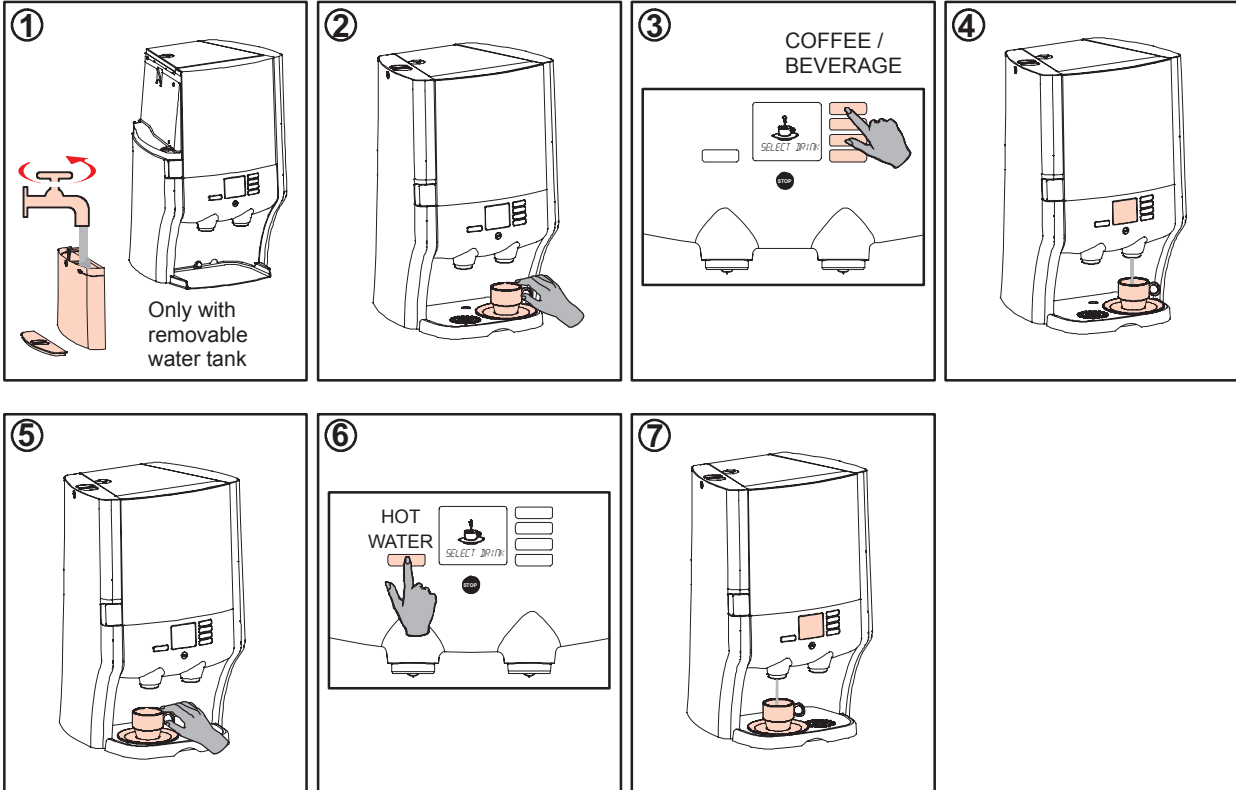

Daily cleaning

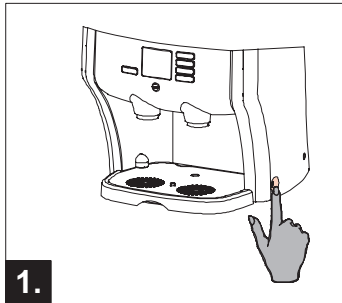

1.

Safety

- Switch the dispenser OFF.

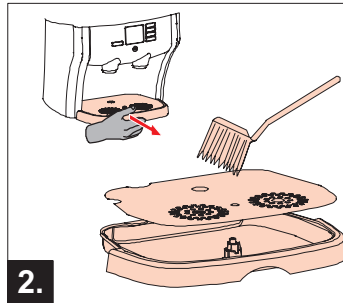

2.

Clean the components

- Remove the drip tray.
- Clean the drip tray.
- Replace the drip tray.

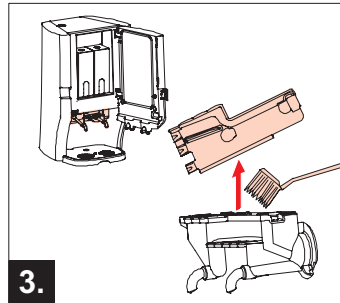

3.

- Open the door and remove the trough (see 5, periodic cleaning)
- Remove the trough cover.
- Clean both parts
- Replace the clean trough.

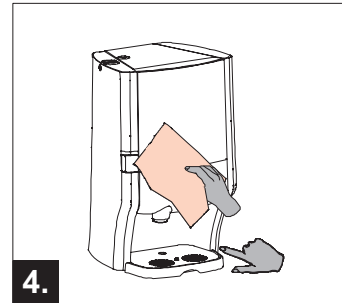

4.

Take into use

- Clean the exterior with a clean damp cloth
- Switch the dispenser ON.

Periodic cleaning

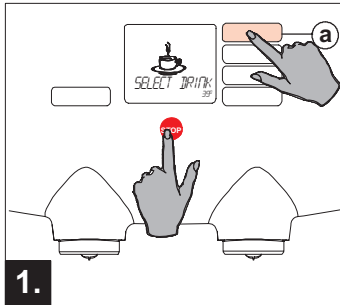

1.

Access the menu

- Keep the stop button pressed.
- Press the selection button (a) until **OPERATOR MODE** appears in the display.

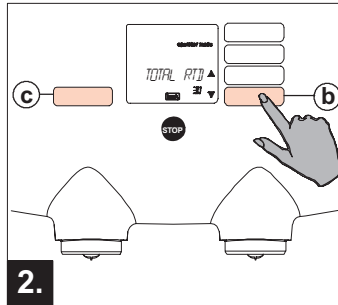

2.

Start cleaning

- Press (b) until **CLEAN** appears in the display.
- Press (c) enter 2x, follow the instructions in the display.

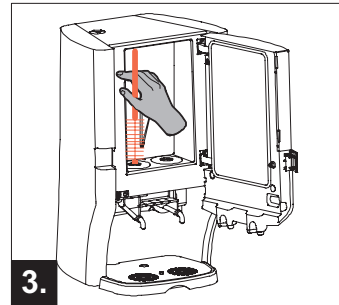

3.

Cooling compartment

- Open the door.
- Remove the ingredient packs.
- Clean the openings with water and a brush.

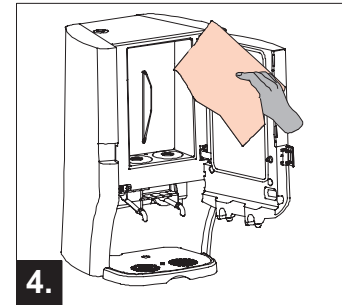

4.

Cooling compartment

- Clean the interior with a clean damp cloth.
- Press the enter button (c).
- Replace both packs.

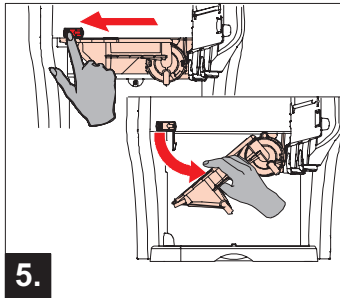

5.

Remove the trough

- Move the red slide to the left.
- Rotate the trough downward and take it out the dispenser.

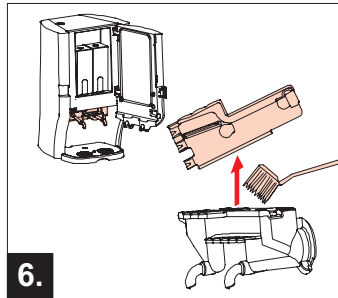

6.

Clean the trough

- Remove the trough cover.
- Clean both parts.
- Replace the clean trough.

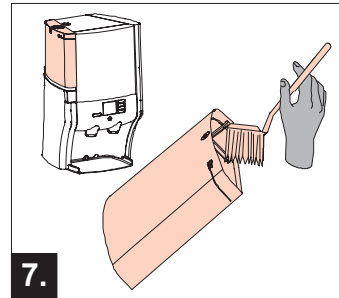

7.

Water tank (option)

- Rinse the water tank.
- Clean the interior of the water tank.
- Replace the water tank.

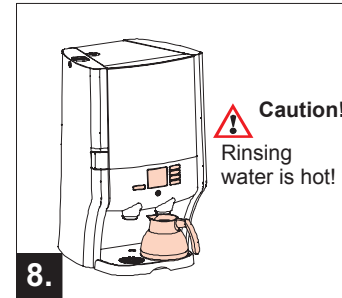

8.

Flushing

- Position a pot underneath the **right-hand** outlet.
- Press (c) enter 2x.
- The dispenser is ready for use.

Specifications

Dispenser	Dimensions	(H) 675 mm / 26.6 inch x (W) 420 mm / 16.5 inch x (D) 400 mm / 15.7 inch
	Weight	Weight empty: 26.5 kg, filled with water and 2 packs: 31.5 kg / 33.5 kg (with separate water tank)
Dispensing points	Dispensing	Hot water (left), coffee and/or other drinks (e.g. cappuccino) (right)
	Cup capacity	Adjustable 40 - 999 ml / 1.2 - 30.4 fl oz (factory setting = 1.25 ml / 3.75 fl oz)
	Cup dispensing time	9 - 10 seconds (125 ml / 3.75 fl oz)
	Decanter capacity	Adjustable 40 - 999 ml / 1.2 - 30.4 fl oz (factory setting = 900 ml / 30.4 fl oz)
	Decanter dispensing time	± 45 seconds
	Time interval between two decanters	120 sec. (230 V) / 188 sec. (120 V) / 228 sec. (110 V)
	Maximum cup/decanter height	132 mm / 5.20 inch
Power supply		120 – 230 V 50 / 60 Hz
Power consumption (fixed)		2.1 kW – 230 V / 1.7 kW – 120 V
Capacity		160 cups per hour at 230 V (± 20 liter p/h) 116 cups per hour at 120 V (± 14.5 liter p/h) 100 cups per hour at 100 V (± 12.5 liter p/h)
Environment	Temperature	1 °C – 32 °C (34 °F – 90°F) for both operation and storage
	Humidity	Up to 80% RH
Cooling compartment	Capacity	2x 1.25 liter / 43/2 fl oz
	Temperature	2 °C – 5 °C (35.6 °F – 41 °F)
International boiler	Capacity	2.25 liter / 76.1 fl oz
	Temperature range	Adjustable between 83 °C – 97 °C (181.4 – 206.6 °F)
Cold water supply		Removable cold water tank, capacity 2.9 liter / 98.1 fl oz or a fixed water connection
Standard accessories		Insulated 900 ml / 30.4 fl oz coffee decanter (extra decanters can be supplied)

Subject Index

A

AED, 28
Almost Empty setting, 28
Almost Empty Detection, 28

B

Beverage outlets, 18
Bucket, 32

C

Capacity, 43
Cleaner, 20
Cleaning, 18
Cleaning frequency, 20
Cleaning program, 20-23
Clock setting, 24
Coffee, 36, 43
Coffee pot, 11
Continuous dispensing, 10, 12
Cooling compartment, 9, 43
Cooling system, 7
Counter readings, 16

D

Daily cleaning, 18-19
Date, 24
Decaffeinated coffee, 1
Descaling, 31
Descaling opening, 33
Descaling program, 32
Descaling warning, 31
Dimensions, 43
Dishwasher, 19, 23
Dispensing, 10-12
Dispensing spout, 9
Display messages, 36-39
Display pictograms, 5
Drain hose, 13
Draining, 13, 33
Drinking water, 3, 8
Drip tray, 2, 18

E

Electricity, 3
Expiration date, 3

F

Failures, 37-38
Filling, 8
Funnel, 33

H

Hot water, 12
Humidity, 43

I

Important parts, 4
Ingredient packs, 1, 3, 4

L

Language setting, 26

M

Milk, 1
Moving, 13-14

O

Operating panel, 6
Operation, 2
Operator menu, 15

P

Periodic cleaning, 20-23
Pot button, 11
Power supply, 43
Programming, 15
Programming buttons, 6

R

Refrigerator, 2, 3
Renegite, 33
Replace, 9

S

Safety instructions, 2-3
Specifications, 43
Storage, 35
Strength setting, 30
Surrounding temperature, 2
Switch on, 7
Switching off, 7

T

Tap, 3
Taste, 30
Text setting, 27
Time, 24
Troubleshooting, 36-39
Trough, 4, 19, 23, 38

U

Use, 7-12
Use-by date, 9

V

Ventilation, 2
Volume setting, 29

W

Water filter, 3
Weight, 43